

2003 TRAFFIC VOLUMES GENERAL HIGHWAY MAP LE SUEUR COUNTY MINNESOTA

PREPARED BY THE
MINNESOTA DEPARTMENT OF TRANSPORTATION
PROGRAM SUPPORT GROUP
IN COOPERATION WITH
THE U.S. DEPARTMENT OF TRANSPORTATION
FEDERAL HIGHWAY ADMINISTRATION



2003
BASIC DATA - 1977

PROJECTION:
Minnesota Coordinate System
North American Datum
of 1983
Lambert Conformal Conic



LEGEND

ROAD AND TRAVELWAY FEATURES

Interstate	State	County	Local	Other
Interstate	State	County	Local	Other
Interstate	State	County	Local	Other
Interstate	State	County	Local	Other
Interstate	State	County	Local	Other
Interstate	State	County	Local	Other

ROAD AND TRAVELWAY FEATURES

Interstate	State	County	Local	Other
Interstate	State	County	Local	Other
Interstate	State	County	Local	Other
Interstate	State	County	Local	Other
Interstate	State	County	Local	Other
Interstate	State	County	Local	Other

ROAD AND TRAVELWAY FEATURES

Interstate	State	County	Local	Other
Interstate	State	County	Local	Other
Interstate	State	County	Local	Other
Interstate	State	County	Local	Other
Interstate	State	County	Local	Other
Interstate	State	County	Local	Other

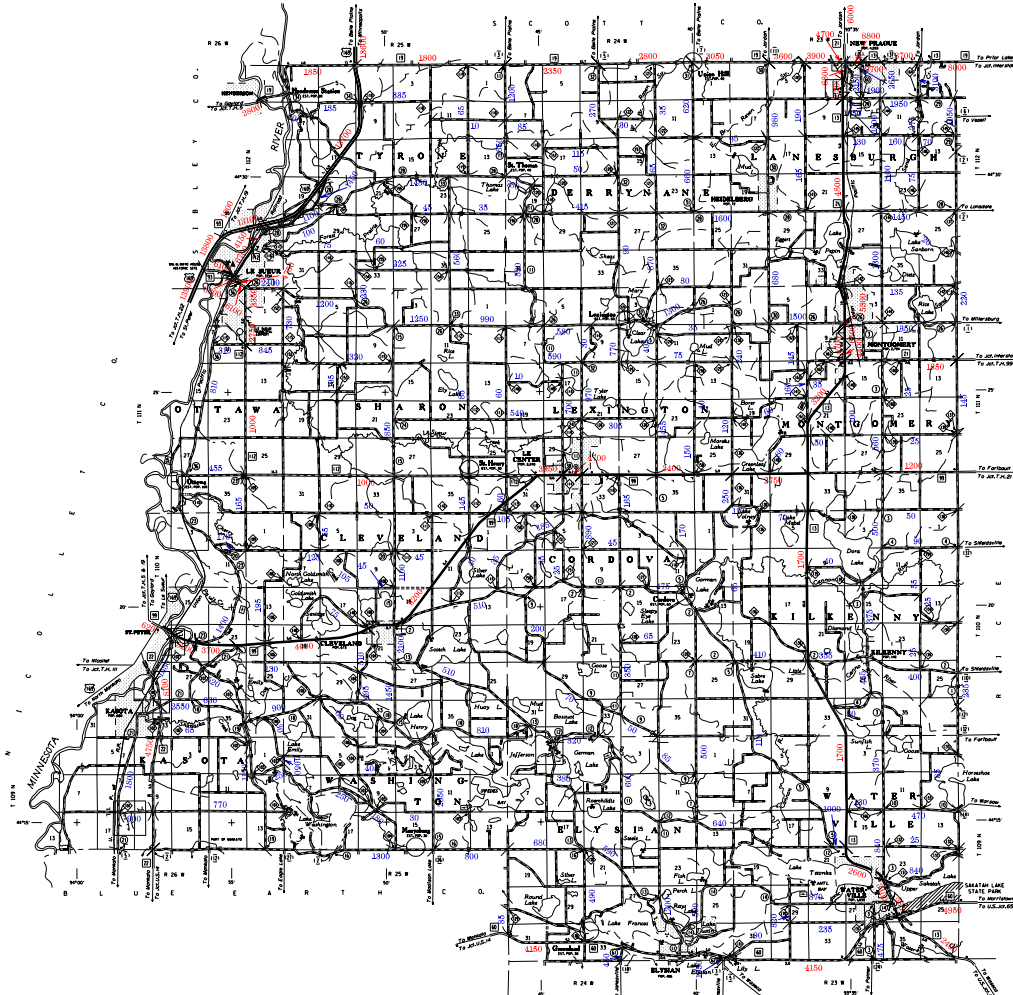

VOLUMES PREPARED BY
THE OFFICE OF
TRANSPORTATION DATA & ANALYSIS

NUMERALS INDICATE AVERAGE DAILY
TRAFFIC VOLUMES ON DESIGNATED ROADS.
TRUNK HIGHWAY ROUTES ARE 3000 A.A.D.T. VOLUMES.
COUNTY SYSTEM ROADS ARE 3008 A.A.D.T. VOLUMES.

FOR DESIGNATED ROADS:
/ = SEGMENT ENDPOINT FOR ALL
ROADS INTERSECTED BY LARCH
= SEGMENT ENDPOINT ONLY FOR
ROAD SEPARATED FROM INTERSECTING
ROAD BY ARC

*METRIC FIGURES EXCEPT LENGTHS, ARE
CUSTOM AND CURRENT AS OF JANUARY 1, 2005.
MILES PER QUARTER OF COUNTY STATE AD-ADVISORY AND COUNTY
ROADS IN INCORPORATED PLACES, SEE MAPS OF INCORPORATED PLACES

