

PREPARED BY  
HIGHWAY PLANNING SURVEY  
IN COOPERATION WITH  
U.S. PUBLIC ROADS ADMINISTRATION

STATE OF MINNESOTA  
DEPARTMENT OF HIGHWAYS  
ROAD LIFE STUDIES  
CONSTRUCTION PROJECT LOG RECORD

CONTROL SECTION 7910  
TRUNK HIGHWAY 235  
COUNTY Traverse  
DISTRICT 4B

LIMITS: E. end of Interstate Bridge - Jct. T.H. 75

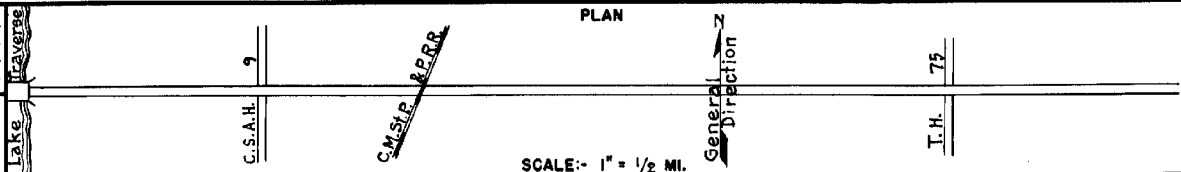

YEAR BUILT	PROJECT N°	DESCRIPTION				CODE N°
		TYPE	WIDTH	THICKNESS	REMARKS	
		Gravel	24'		No Record of Const. Added in 1949	
C	A.F.E. 16	Bit Surfacing Bit. Surf. Treat.	24'	3/4"	SC-38 MC-1, 19224 Gal. Agg. 296 CY.	
M	A.F.E. 6	Grav. Resurfacing	24'		900 CY.	
M	A.F.E. 604	Bit. Surf. Repair Bit. Seal (0.80 Mi.)	24'		SC-38 MC-2, 11664 Gal. Agg. 553 C.Y.	
M	A.F.E. 604	Bit. Surf. Repair	24'		SC-3, 2530 Gal. Agg. 168 Tons	
M	A.F.E. 604	Bit. Seal Coat (Surf. Repair)	22'		RC-2, 1350 Gal. Agg. 49 Tons	
C	A.F.E. 818 2/1960	Gravel Base Road Mix Bit.	28' 25'	6" 1"	18,721 Tons MC-0 & MC-2, 7137 Gal. Agg. 4236 Tons	
R	1977 7710-03 for 600s (45)	Traffic Barrier Instl.			Rt. No. 6960	

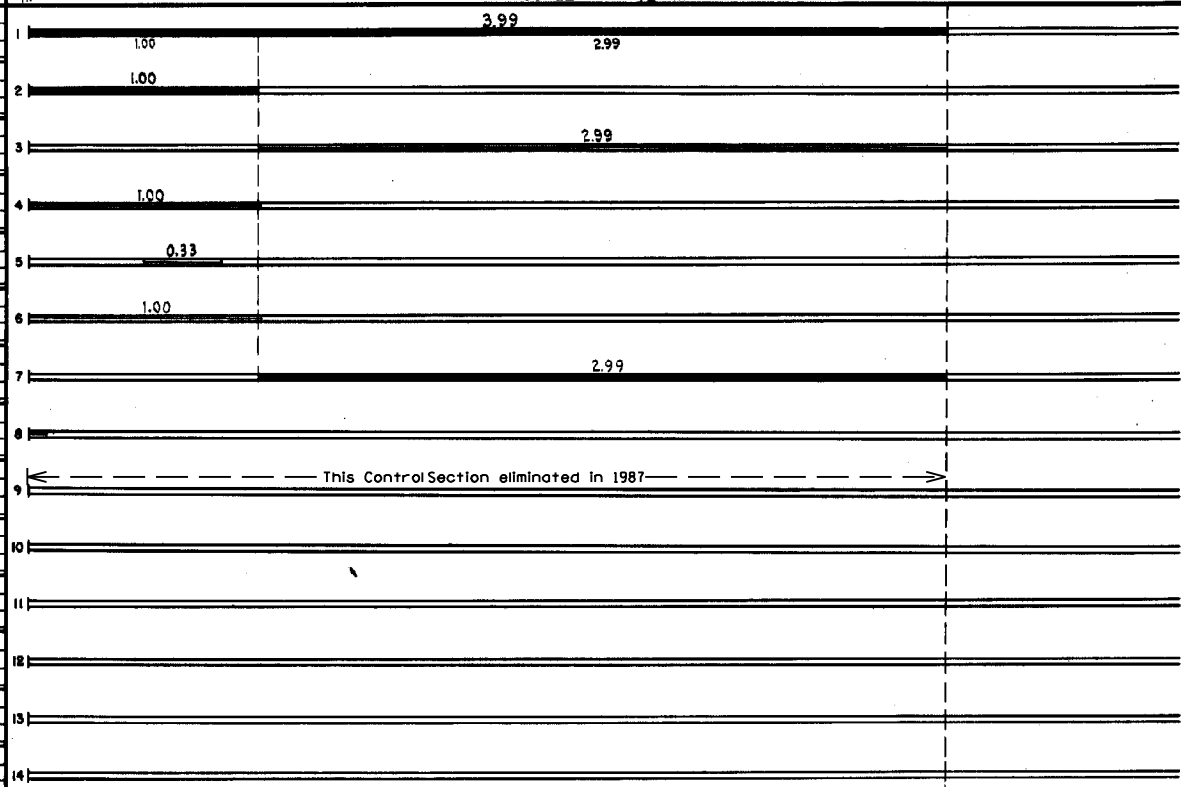

YEARS		TOTAL MILES	UNINCORPORATED		INCORPORATED		RURAL		URBAN		REMARKS: Layout is to scale as of 1949
FROM	TO		RDWY. MI.	BR. MI.	RDWY. MI.	BR. MI.	RDWY. MI.	BR. MI.	RDWY. MI.	BR. MI.	
1949		3.99	3.99	0.00	0.00	0.00	3.99	0.00	0.00	0.00	