

PREPARED BY
TRAFFIC AND PLANNING DIVISION
IN COOPERATION WITH
U.S. DEPARTMENT OF COMMERCE
BUREAU OF PUBLIC ROADS

STATE OF MINNESOTA
DEPARTMENT OF HIGHWAYS
ROAD LIFE STUDIES
CONSTRUCTION PROJECT LOG RECORD

CONTROL SECTION 6909
TRUNK HIGHWAY 61
COUNTY St. Louis
DISTRICT 1A1

LIMITS: (In Duluth) Jct. T.H.35 - Jct. T.H.2 (Central Ave.)

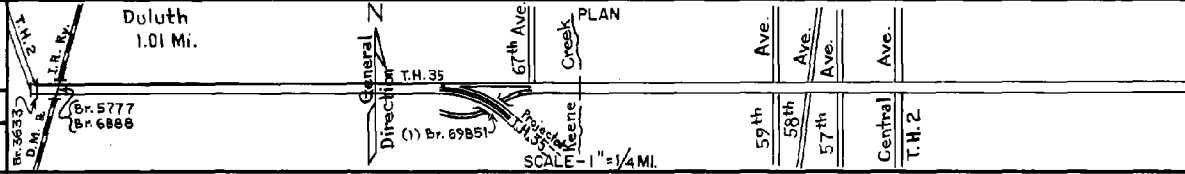

YEAR BUILT	PROJECT NO	DESCRIPTION			REMARKS
		TYPE	WIDTH	THICKNESS	
1923	R/W Map S.P. 103-28	Concrete	30'		
1924	R/W Map S.P. 103-28	Concrete	30'		
1934	X-103-23	Concrete	40' 7 1/2"		
1941	6909-05	Br. 5777 Bridge Widening			
M 1943	AFE-20	Clean ditches Fill Washouts			
M 1944	AFE 30	Bit. Surf. Repair	30'-40'	1 1/2"	
M 1950	AFE 36	Reshaping & Gravel Shoulders			
C 1950	6909-15	Pl. Mix. Bit. over concrete in place	20'-27'	3"	
C 1956	6909-19	Br. 6888			75' T.P.G. - U.P. N.B. Rdwy.
C 1957	6909-21	Grading	2@41'		
C 1957	6909-08	Grading-Sub-base Bit. Stab. Base Asphaltic Conc.	35'-44' 35'-44'	10'-13" 8"	
C 1961	6909-26 6909-28	Grading-Base Grav. & Conc. Asphaltic Conc. Traffic Signals	24'-32' 2@24'	7 1/2" 3"	57th Ave. & Cody St. W. Jct. T.H. 2 & 61 Yellow T.H. 61 Red T.H. 2
C 1963	6909-29	Flasher Signal			
C 1967	6982-14	Grading & Base P.C. Conc.			0.06 Both Rdwys 0.12 N.B. Conn.

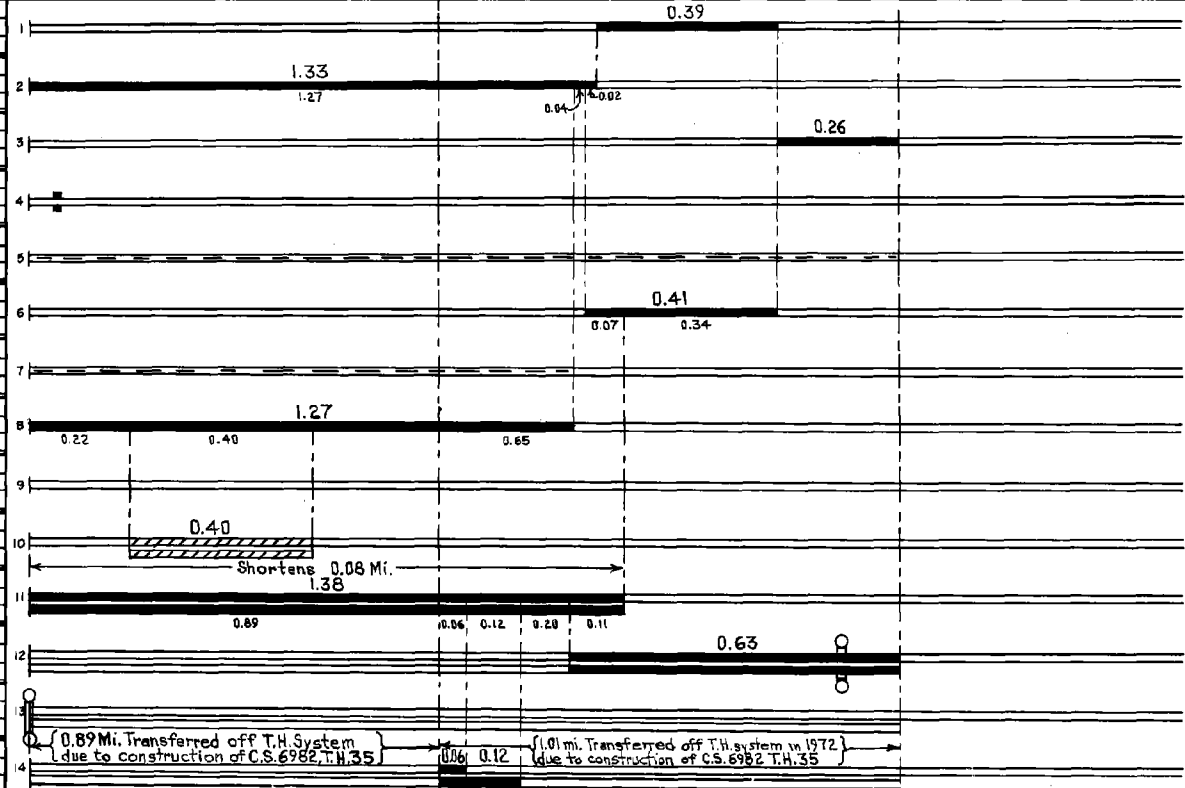

YEARS FROM	TO	TOTAL MILES	UNINCORPORATED		INCORPORATED		RURAL		URBAN	
			RDWY. MI.	BR. MI.	RDWY. MI.	BR. MI.	RDWY. MI.	BR. MI.	RDWY. MI.	BR. MI.
1923	1957	1.98	0.00	0.00	1.98	0.00	0.00	0.00	1.98	0.00
1957	1967	1.90	0.00	0.00	1.90	0.00	0.00	0.00	1.90	0.00
1967	1971	1.01	0.00	0.00	1.01	0.00	0.00	0.00	1.01	0.00
1972		0.00	0.00	0.00	0.00	0.00	0.00	0.00	0.00	0.00

REMARKS: Layout is to scale as of 1969.
(1) Br. 6985 T.H. 35 over N.B. T.H. 61 conn. (See C.S. 6982)