

PREPARED BY
HIGHWAY PLANNING SURVEY
IN COOPERATION WITH
U. S. PUBLIC ROADS ADMINISTRATION

STATE OF MINNESOTA
DEPARTMENT OF HIGHWAYS
ROAD LIFE STUDIES
CONSTRUCTION PROJECT LOG RECORD

CONTROL SECTION 4814
TRUNK HIGHWAY 169
COUNTY Mille Lacs
DISTRICT 3A

LIMITS: N. Jct. T.H. 27 (along Mille Lacs Lake) - N. Co. Line

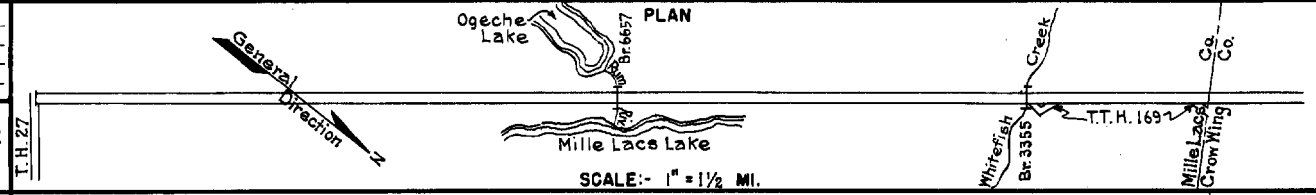

YEAR BUILT	PROJECT N°	DESCRIPTION			CODE N°
		TYPE	WIDTH	THICKNESS	
1921	169-18-2A,B&C	Grading Gravel Br. 3354 & 3355	24' 20' 19'	2" 3 1/2" 1 1/2"	1400 C.Y./Mile. 45' L.I. & 16' C.S.
	(i)				
1928	169-18-2A,B&C	Tar Tr. Gravel	24'	1 1/2"	10215 Gal./Mile. Maint. Dept.
	(i)				
1928	169-18-2C	Oil Tr. Gravel	24'	1 1/2"	10215 Gal./Mile. Maint. Dept.
1938	169-18-2C	Br. 3355	230'		16' C.S. Widening
1939	4814-02	Roadside Develop.			
1939	4814-03	Roadside Develop.			Clearing & Grub. on New Line.
C	1940 4814-09	Roadside Develop.			Mono Culvert on New Line.
M	1940 A.F.E. 35	Spot Treat. Bit Surf. Repair			SG 3,391 Gal./Mi. Grav. 22 C.Y./Mi. Maint. Dept.
C	1941 4814-07	Grading Stab. Earth Gravel	34' 34' 34'	4" 1/2"	
C	1941 4814-07	Grading Gravel Mono. Culv.	38' 38'	1"	C57X40.
C	1941 4814-14	Stab. Grav. Base Mixed Bit.	31' 26'	3'-6" 1"	
M	1941 A.F.E. 22	Spot Treat. Bit Surf. Repair	24'		SG 3,198 Gal./Mi. Grav. 69 C.Y./Mi. Maint. Dept.
M	1942 A.F.E. 4 A.F.E. 5	Spot Treat. Bit Surf. Repair (Spot) Seal Coat	24' 22'		SG 3b & RF 6,345 G./M. Agg. 195 C.Y./Mi. Maint. Dept.
C	1942 A.F.E. 7	Seeding			Seed supplied by R.S.D. (S.P. 4814-13) Maint. Dept.

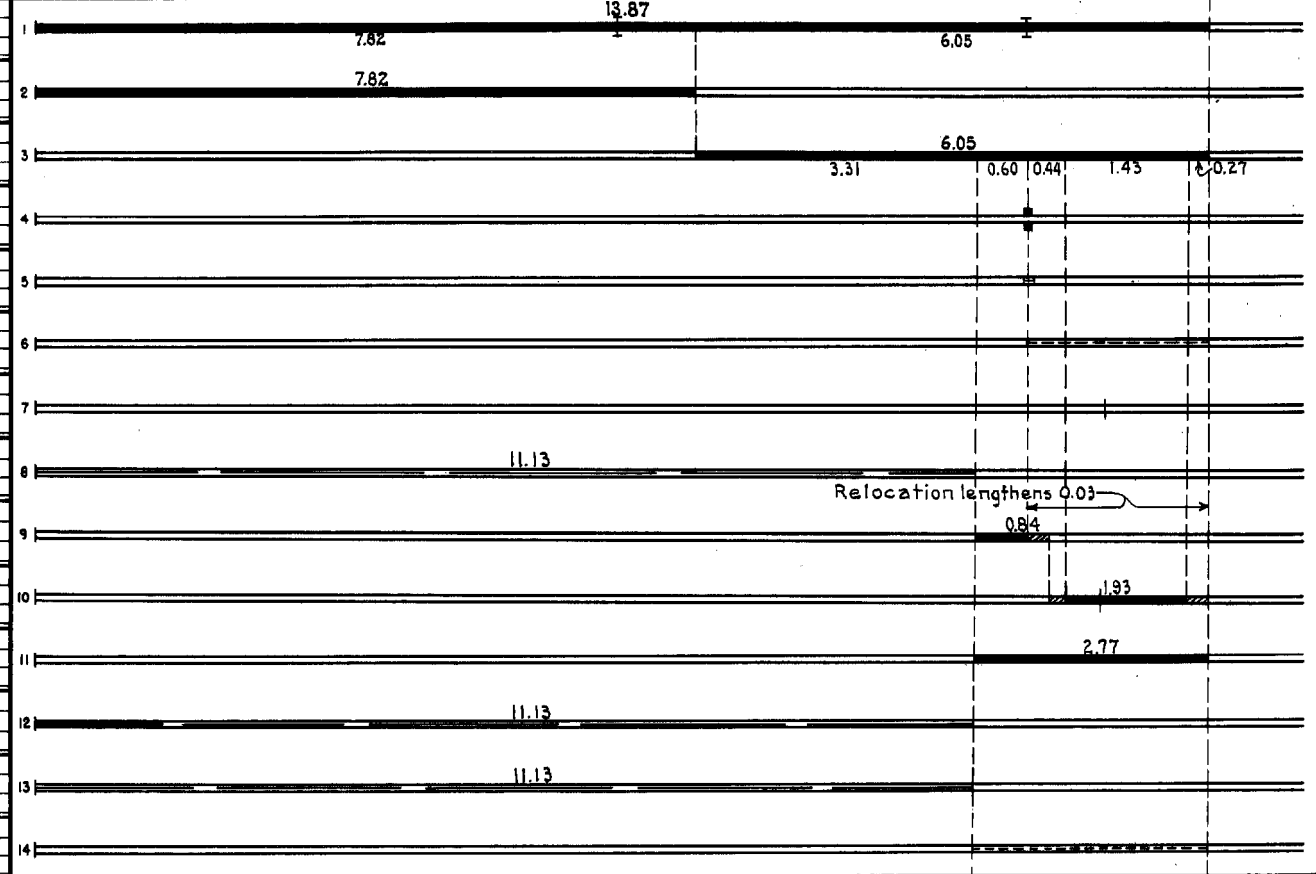

YEARS FROM	TO	TOTAL MILES	UNINCORPORATED		INCORPORATED		RURAL		URBAN	
			RDWY. MI.	BR. MI.	RDWY. MI.	BR. MI.	RDWY. MI.	BR. MI.	RDWY. MI.	BR. MI.
1921	1940	13.87	13.86	0.01	0.00	0.00	13.85	0.01	0.00	0.00
1941	1947	13.90	13.89	0.01	0.00	0.00	13.89	0.01	0.00	0.00
1948	1950	13.84	13.83	0.01	0.00	0.00	13.83	0.01	0.00	0.00
1951		13.67	13.66	0.01	0.00	0.00	13.66	0.01	0.00	0.00

REMARKS: Layout is to scale as of 1921

(i) This work not done under these project numbers but lies within the limits of these projects.

