

PREPARED BY
HIGHWAY PLANNING SURVEY
IN COOPERATION WITH
U. S. PUBLIC ROADS ADMINISTRATION

STATE OF MINNESOTA
DEPARTMENT OF HIGHWAYS
ROAD LIFE STUDIES
CONSTRUCTION PROJECT LOG RECORD

CONTROL SECTION 4805
TRUNK HIGHWAY 18
COUNTY Mille Lacs
DISTRICT 1A

LIMITS: N. Jct. T.H. 47 - E. Co. Line

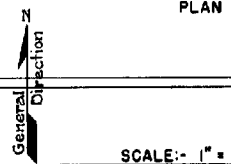

SCALE: - 1" = 1/4 MI.

St. Co.
Mille Lacs
Aitkin

YEAR BUILT	PROJECT N°	DESCRIPTION		CODE N°	T.H.P.
		TYPE	WIDTH THICK NESS		
		Gravel	20' 2.7		
				No Record of Constr Added in 1934	
M 1949	A.F.E. 6	Grav. Resurfacing	24'	688 CY	
M 1953	A.F.E. 606	Grav. Resurfacing (Spots)		497 Tons	
M 1958	A.F.E. 606	Grav. Resurfacing		82.9 Tons	

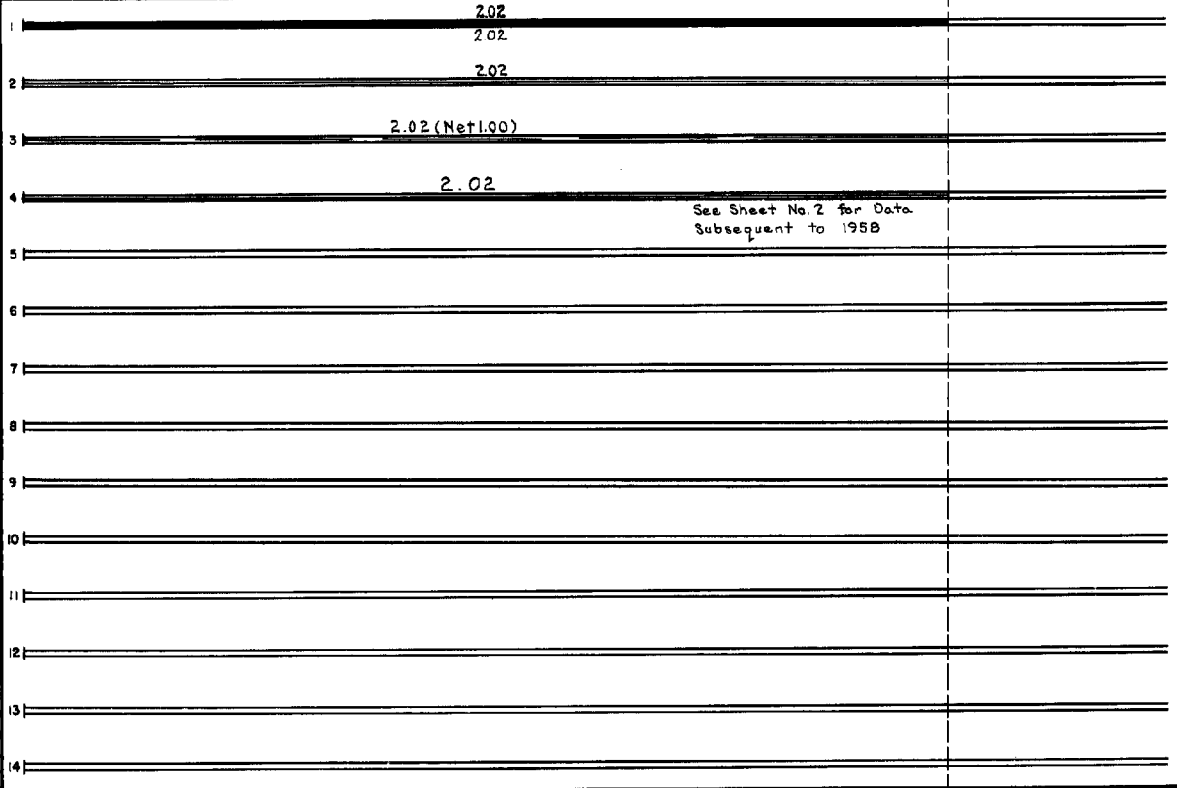

YEARS FROM TO	TOTAL MILES	UNINCORPORATED		INCORPORATED		RURAL		URBAN	
		RDWY. MI.	BR. MI.	RDWY. MI.	BR. MI.	RDWY. MI.	BR. MI.	RDWY. MI.	BR. MI.
1934	2.02	2.02	0.00	0.00	0.00	2.02	0.00	0.00	0.00

REMARKS: Layout is to scale as of 1934

PREPARED BY
TRAFFIC AND PLANNING DIVISION
IN COOPERATION WITH
U.S. DEPARTMENT OF COMMERCE
BUREAU OF PUBLIC ROADS

STATE OF MINNESOTA
DEPARTMENT OF HIGHWAYS
ROAD LIFE STUDIES
CONSTRUCTION PROJECT LOG RECORD

CONTROL SECTION 4805
TRUNK HIGHWAY 18
COUNTY Mille Lacs
DISTRICT 1A

LIMITS: Jct. T.H. 47 - E. Co. Line

Ref. Pt. 047+00.413 - 050+00.742

YEAR BUILT	PROJECT NO.	DESCRIPTION				REMARKS
		TYPE	WIDTH	THICKNESS		
C 1968	4805-03	Grade, Gravel Surf.	50'			1200 C.Y./Mi.
C 1969	4805-04	* Grade-Subbase & Base Rd. Mix. Bit. Base Pl. Mix. Bit. Surf.	26'	9" 1" 1 1/2"		*Sub-base 6" Sand-Grav. Base 3' Gravel
C 1969	4805-05	Gravel Base Pl. Mix. Bit. Base Pl. Mix. Bit. Surf.	24'	13 1/4" 1 1/2" 2"		
C 1993	4805-07	Bit. Overlay	24'	1 1/2"		Spec. 2341

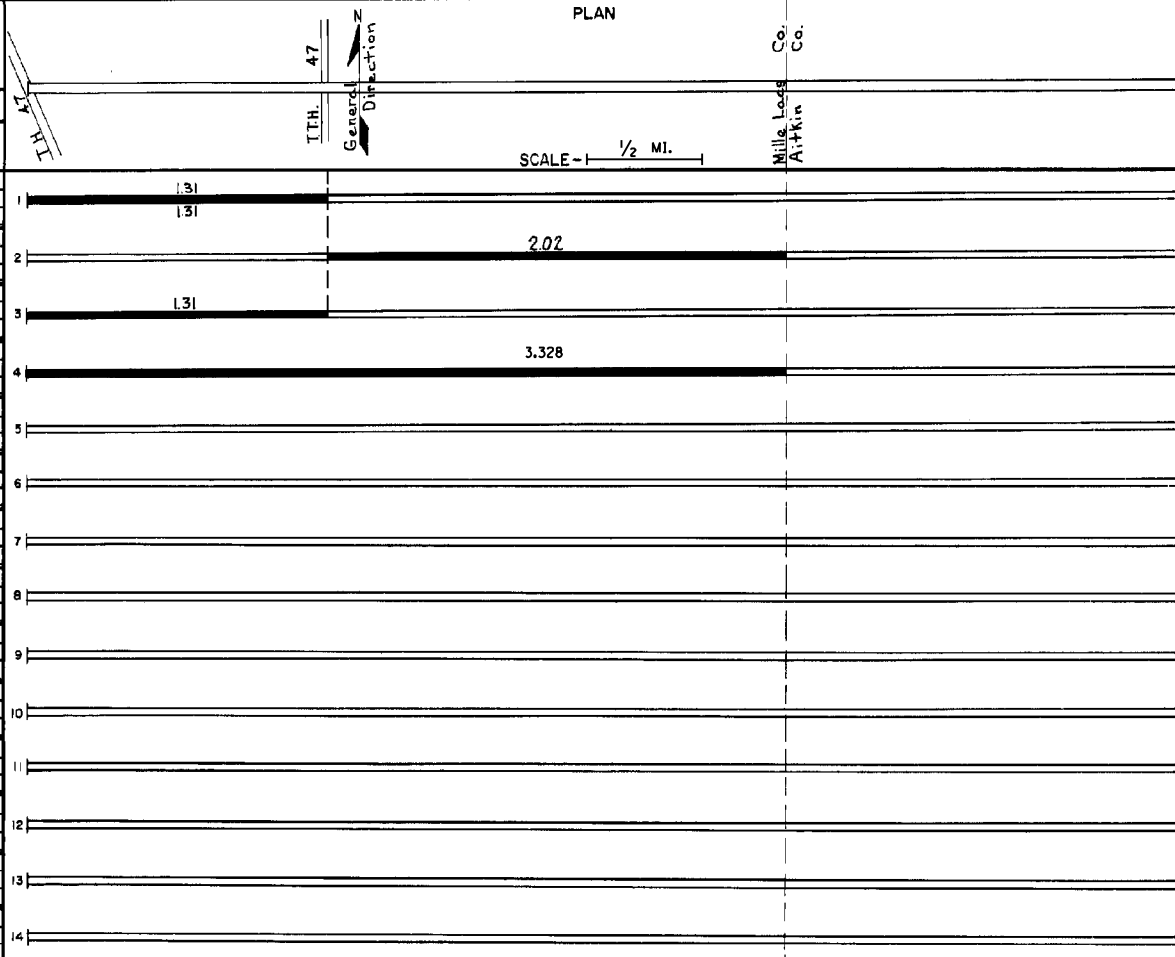

YEARS		TOTAL MILES	UNINCORPORATED		INCORPORATED		RURAL		URBAN		
FROM	TO		RDWY. MI.	BR. MI.	RDWY. MI.	BR. MI.	RDWY. MI.	BR. MI.	RDWY. MI.	BR. MI.	
1968		3.33	3.33	0.00	0.00	0.00	0.00	3.33	0.00	0.00	0.00

REMARKS: Layout is to scale as of 1968