

PREPARED BY
HIGHWAY PLANNING SURVEY
IN COOPERATION WITH
U.S. PUBLIC ROADS ADMINISTRATION

STATE OF MINNESOTA
DEPARTMENT OF HIGHWAYS
ROAD LIFE STUDIES
CONSTRUCTION PROJECT LOG RECORD

CONTROL SECTION 0107
TRUNK HIGHWAY 200
COUNTY Atkin
DISTRICT 1A

LIMITS: N. Jct. T.H. 65 - Jct. T.H. 2
Ref. Pt. 191+00.949 - 201+00.318

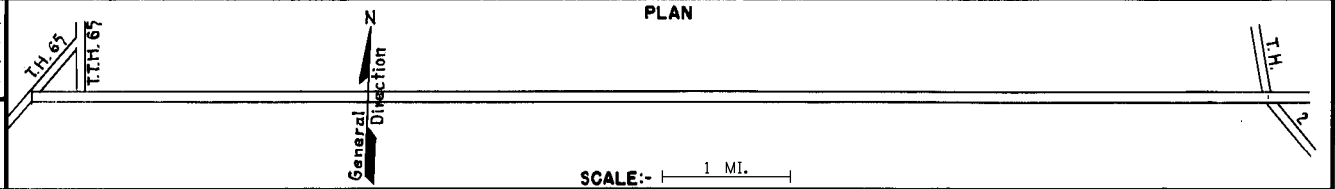

| YEAR BUILT | PROJECT N° | DESCRIPTION | | | CODE N° |
|------------|-----------------|---|-------------------|--------------------|--|
| | | TYPE | WIDTH | THICKNESS | |
| 1929 | | Grading Gravel | 24' | 2" | Co. Job N° 2802. 800 C.Y./Mile. Added in 1934. |
| M | 1940 A.F.E. 38 | Regraveling | | | 158 C.Y./Mi. Maint. Dept. |
| M | 1941 A.F.E. 37 | Regraveling | 20' | | 300 C.Y./Mi. Maint. Dept. |
| M | 1948 A.F.E. 6 | Grav. Resurfacing | | | 3737 C.Y. |
| 1928 | | Gravel | 30' | 4" | |
| M | 1950 A.F.E. 6 | Gravel Resurfacing | | | 6703 Tons |
| M | 1952 A.F.E. 12 | Grav. Resurfacing (Spots) | | | 504 C.Y. |
| M | 1953 A.F.E. 606 | Grav. Resurfacing (Spots) | | | 3010 Tons |
| C | 1957 0107-02 | Grading Gravel | 40' 32' | 2" | 1200 C.Y./Mi. |
| C | 1958 0107-03 | Sand-Grav. Subbase Gravel Base Plant Mix Bit. | 32' 32' 24' | 6" 4" 1 1/2" | |
| M | 1961 | Light Bit. Seal | 25' | | R5-2, 16625 Gal. Agg. 680 C.Y. |
| C | 1978 0107-05 | Bit. Resurfacing Pl. Mix Bit. Shoulders | 24' 4' | 2 1/2" 1 1/2" | |
| C | 1999 0107-06 | Bit. Surfacing | 32' | 1 1/2" | Spec. 2360 |
| 2012 | 0107-07 | Grading Milling Bituminous Overlay | | 2" 3.5" | Spec. 2360 |

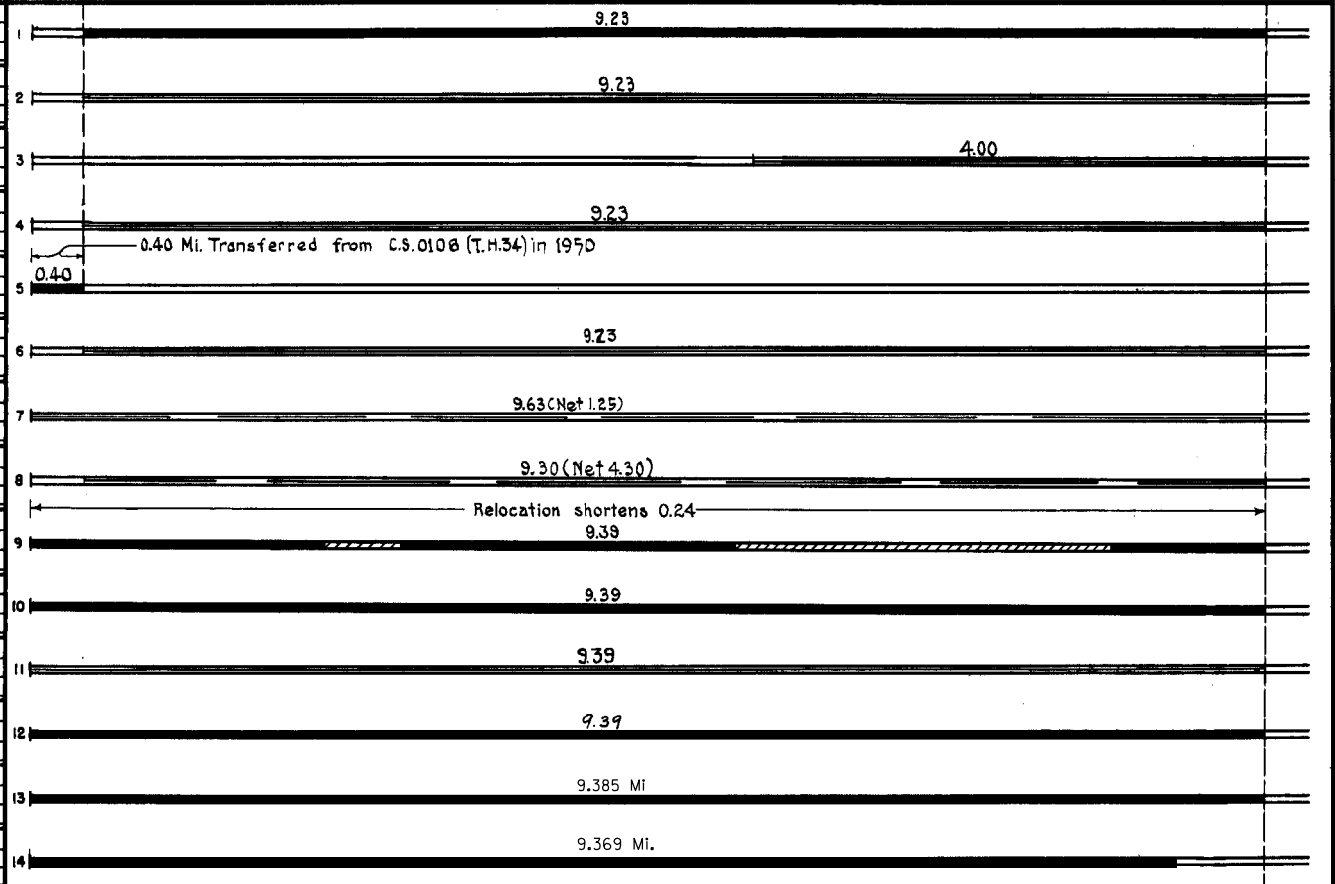

| YEARS | | TOTAL MILES | UNINCORPORATED | | | INCORPORATED | | | RURAL | | URBAN | |
|-------|------|-------------|----------------|---------|-----------|--------------|-----------|---------|-----------|---------|-------|--|
| FROM | TO | | RDWY. MI. | BR. MI. | ROWY. MI. | BR. MI. | RDWY. MI. | BR. MI. | RDWY. MI. | BR. MI. | | |
| 1934 | 1949 | 9.23 | 9.23 | 0.00 | 0.00 | 0.00 | 9.23 | 0.00 | 0.00 | 0.00 | | |
| 1950 | 1956 | 9.63 | 9.63 | 0.00 | 0.00 | 0.00 | 9.63 | 0.00 | 0.00 | 0.00 | | |
| 1957 | | 9.39 | 9.39 | 0.00 | 0.00 | 0.00 | 9.39 | 0.00 | 0.00 | 0.00 | | |

REMARKS: Layout is to scale as of 1934