

TOWNSHIP OF TYRO

PREPARED BY THE
MINNESOTA DEPARTMENT OF TRANSPORTATION
OFFICE OF TRANSPORTATION SYSTEM MANAGEMENT

IN COOPERATION WITH
U.S. DEPARTMENT OF TRANSPORTATION
FEDERAL HIGHWAY ADMINISTRATION

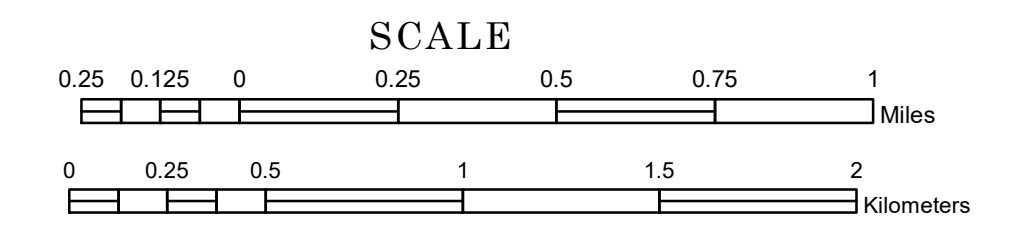

2024

Projection:
Transverse Mercator
NAD 1986
UTM Zone 15

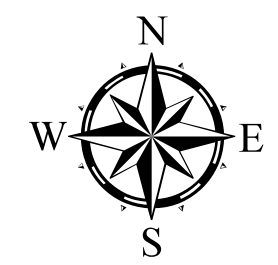

North American Datum
of 1986

ROAD AND ROADWAY FEATURES		AVIATION FEATURES	
INTERSTATE	CONCRETE	COMMERCIAL AIRPORT	GENERAL AIRPORT
US HIGHWAY	BITUMINOUS	AIRSTRIP	SEAPLANE
MN HIGHWAY	GRAVEL	AIRPORT RUNWAY	BOUNDARY FEATURES
COUNTY STATE AID HIGHWAY	DIRT/UNIMPROVED	TRIAL LAND	STATE OF MINNESOTA
COUNTY ROAD	OTHER	COUNTY	MUNICIPALITY
TOWNSHIP ROAD	UNKNOWN	UNORGANIZED TERRITORY	FEDERAL ADJUSTED URBAN AREA (2014)
UNORGANIZED TERRITORY ROAD		CIVIL TOWNSHIP	CONGRESSIONAL TOWNSHIP
OTHER ROADS		SECTION	MILITARY
Municipal	RAMP OR CONNECTOR	VOYAGEUR'S NATIONAL PARK	BOUNDARY WATERS GANOE AREA WILDERNESS
Private	INTERSTATE EXIT	STATE PARK	REGIONAL PARK
Nature Service		NATIONAL FOREST	NATIONAL AND STATE FOREST
National Park		STATE FOREST	NATIONAL TRAIL
National Wildlife		WILDLIFE REFUGUE AREA	WILDLIFE MANAGEMENT AREA
State Game		HYDROLOGIC FEATURES	RIVER OR STREAM (PERENNIAL)
State Park		LAKE, POND OR RESERVOIR	STREAM (INTERMITTENT)
Present		WETLAND	DRAINAGE DITCH
		ISLAND OR LAND	REGIONAL WATERSHED

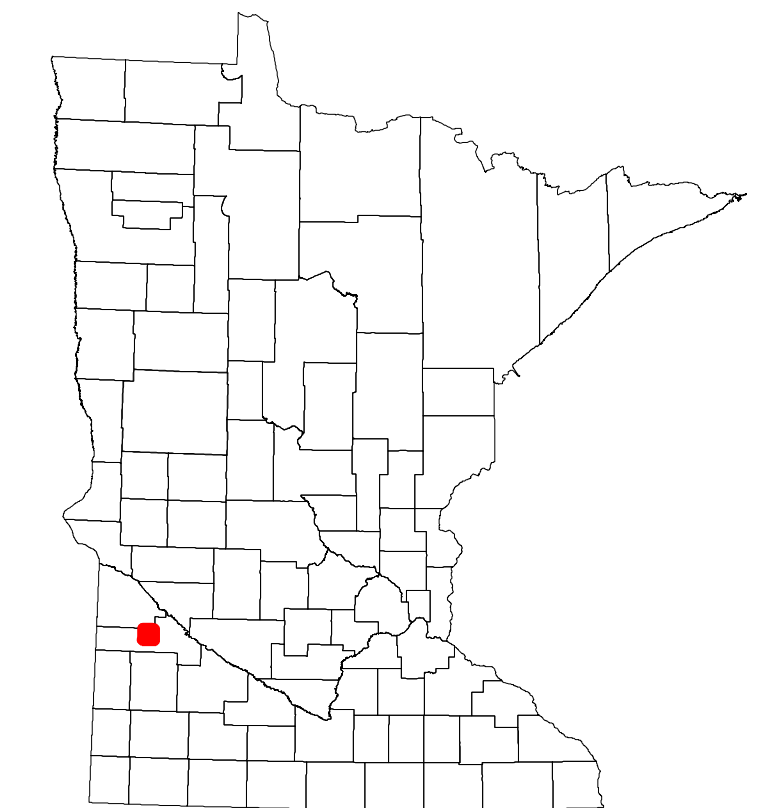

Population (U.S. Census 2010): 181

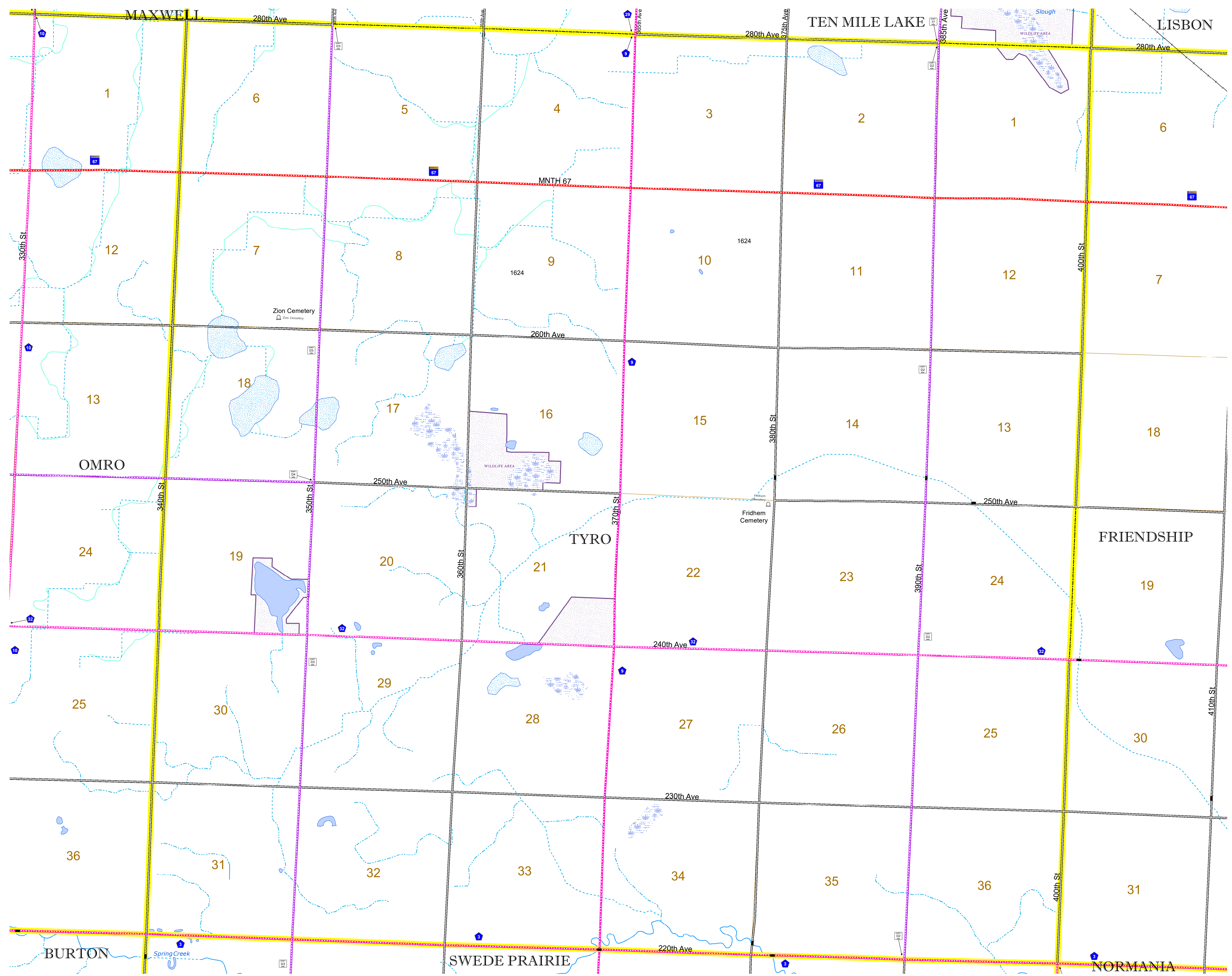

To request information from this document in an alternative format, call 651-366-4718 or 1-800-657-3774 (Greater Minnesota); 711 or 1-800-627-3529 (Minnesota Relay). You may also send an e-mail to ADAREquest.dot@state.mn.us. (Please request at least one week in advance.)