

TOWNSHIP OF DOLLYMOUNT

PREPARED BY THE
MINNESOTA DEPARTMENT OF TRANSPORTATION
OFFICE OF TRANSPORTATION SYSTEM MANAGEMENT

IN COOPERATION WITH
U.S. DEPARTMENT OF TRANSPORTATION
FEDERAL HIGHWAY ADMINISTRATION

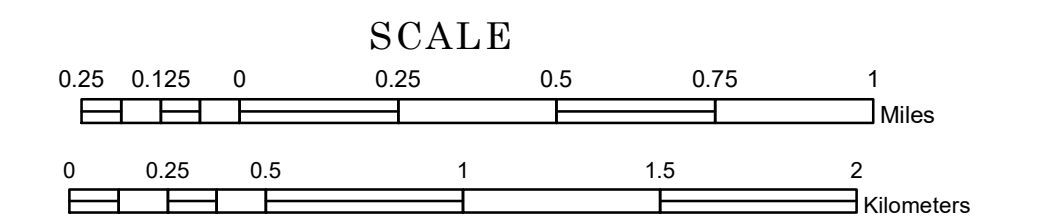

2023

Projection:
Transverse Mercator
NAD 1986
UTM Zone 15

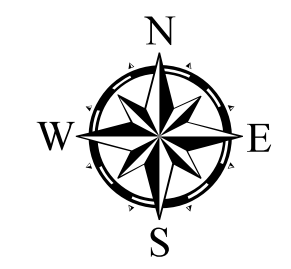

North American Datum
of 1986

ROAD AND ROADWAY FEATURES		AVIATION FEATURES	
INTERSTATE	CONCRETE	COMMERCIAL AIRPORT	GENERAL AIRPORT
US HIGHWAY	BITUMINOUS	AIRSTRIP	SEAPLANE
MN HIGHWAY	GRAVEL	SEAPLANE	AIRPORT RUNWAY
COUNTY STATE AID HIGHWAY	DIRT/UNIMPROVED	SEAPLANE	AIRPORT RUNWAY
COUNTY ROAD	DIRT/UNIMPROVED	SEAPLANE	AIRPORT RUNWAY
TOWNSHIP ROAD	OTHER	SEAPLANE	AIRPORT RUNWAY
UNORGANIZED TERRITORY ROAD	UNKNOWN	SEAPLANE	AIRPORT RUNWAY
OTHER ROADS	RAMP OR CONNECTOR	SEAPLANE	AIRPORT RUNWAY
Municipal	INTERSTATE EXIT	SEAPLANE	AIRPORT RUNWAY
Private	GREAT RIVER ROAD	SEAPLANE	AIRPORT RUNWAY
National Monument	INTERSTATE EXIT	SEAPLANE	AIRPORT RUNWAY
National Park	GREAT RIVER ROAD	SEAPLANE	AIRPORT RUNWAY
National Wildlife Refuge	INTERSTATE EXIT	SEAPLANE	AIRPORT RUNWAY
State Game	GREAT RIVER ROAD	SEAPLANE	AIRPORT RUNWAY
State Park	INTERSTATE EXIT	SEAPLANE	AIRPORT RUNWAY
Preserve	GREAT RIVER ROAD	SEAPLANE	AIRPORT RUNWAY
RAILROAD AND RAILWAY FEATURES		BOUNDARY FEATURES	
EMPIRE BUILDER STATION (AMTRAK)	TRIBAL LAND	STATE OF MINNESOTA	COUNTY
NORTHSTAR STATION (COMMUTER)	STATE OF MINNESOTA	COUNTY	MUNICIPALITY
LIGHT RAIL	UNORGANIZED TERRITORY	UNORGANIZED TERRITORY	FEDERAL ADJUSTED URBAN AREA (2014)
BLUE LINE	FEDERAL ADJUSTED URBAN AREA (2014)	CIVIL TOWNSHIP	CONGRESSIONAL TOWNSHIP
GREEN LINE	CIVIL TOWNSHIP	CONGRESSIONAL TOWNSHIP	SECTION
INFRASTRUCTURE FEATURES		MILITARY	
LONG BRIDGE (200' OR GREATER SPAN)	SECTION	MILITARY	VOYAGEURS NATIONAL PARK
MAJOR BRIDGE (20' TO 200' SPAN)	VOYAGEURS NATIONAL PARK	VOYAGEURS NATIONAL PARK	BOUNDARY WATERS CANOE AREA WILDERNESS
MINOR BRIDGE (5' TO 20' SPAN)	BOUNDARY WATERS CANOE AREA WILDERNESS	BOUNDARY WATERS CANOE AREA WILDERNESS	STATE PARK
DAM	STATE PARK	STATE PARK	REGIONAL PARK
LOCK AND DAM	REGIONAL PARK	REGIONAL PARK	NATIONAL FOREST
CITY CENTERS		NATIONAL AND STATE FOREST	
STATE CAPITAL	NATIONAL FOREST	NATIONAL FOREST	STATE FOREST
COUNTY SEAT	NATIONAL AND STATE FOREST	NATIONAL AND STATE FOREST	WILDLIFE REFUGUE AREA
CITY CENTER	STATE FOREST	STATE FOREST	WILDLIFE MANAGEMENT AREA
UNINCORPORATED COMMUNITY	WILDLIFE REFUGUE AREA	WILDLIFE REFUGUE AREA	WILDLIFE MANAGEMENT AREA
PUBLIC SERVICE FEATURES		HYDROLOGIC FEATURES	
MNDOT OFFICE	WILDLIFE MANAGEMENT AREA	WILDLIFE MANAGEMENT AREA	RIVER OR STREAM (PERENNIAL)
MNDOT TRUCK STATION	WILDLIFE MANAGEMENT AREA	WILDLIFE MANAGEMENT AREA	LAKE, POND OR RESERVOIR
HIGHWAY PATROL DISTRICT OFFICE	WILDLIFE MANAGEMENT AREA	WILDLIFE MANAGEMENT AREA	STREAM (INTERMITTENT)
STATE TRAVEL INFORMATION CENTER	WILDLIFE MANAGEMENT AREA	WILDLIFE MANAGEMENT AREA	DRAINAGE DITCH
REST AREA (FULL SERVICE)	WILDLIFE MANAGEMENT AREA	WILDLIFE MANAGEMENT AREA	WETLAND
REST AREA (VAULT TOILET)	WILDLIFE MANAGEMENT AREA	WILDLIFE MANAGEMENT AREA	ISLAND OR LAND
WAYSIDE (VAULT OR PIT TOILET)	WILDLIFE MANAGEMENT AREA	WILDLIFE MANAGEMENT AREA	REGIONAL WATERSHED
PARK AND RIDE LOT	WILDLIFE MANAGEMENT AREA	WILDLIFE MANAGEMENT AREA	REGIONAL WATERSHED
PORT OF ENTRY	WILDLIFE MANAGEMENT AREA	WILDLIFE MANAGEMENT AREA	REGIONAL WATERSHED
PUBLIC ACCESS POINT	WILDLIFE MANAGEMENT AREA	WILDLIFE MANAGEMENT AREA	REGIONAL WATERSHED
MN STATE COLLEGE AND UNIVERSITY SYSTEM (MNSCU)	WILDLIFE MANAGEMENT AREA	WILDLIFE MANAGEMENT AREA	REGIONAL WATERSHED
UNIVERSITY OF MN SYSTEM	WILDLIFE MANAGEMENT AREA	WILDLIFE MANAGEMENT AREA	REGIONAL WATERSHED
FAIRGROUNDS	WILDLIFE MANAGEMENT AREA	WILDLIFE MANAGEMENT AREA	REGIONAL WATERSHED
CULTURAL FEATURES		HYDROLOGIC FEATURES	
STATE HISTORICAL MARKER	WILDLIFE MANAGEMENT AREA	WILDLIFE MANAGEMENT AREA	RIVER OR STREAM (PERENNIAL)
HISTORIC DISTRICT	WILDLIFE MANAGEMENT AREA	WILDLIFE MANAGEMENT AREA	LAKE, POND OR RESERVOIR
HISTORIC SITE	WILDLIFE MANAGEMENT AREA	WILDLIFE MANAGEMENT AREA	STREAM (INTERMITTENT)
MONUMENT	WILDLIFE MANAGEMENT AREA	WILDLIFE MANAGEMENT AREA	DRAINAGE DITCH

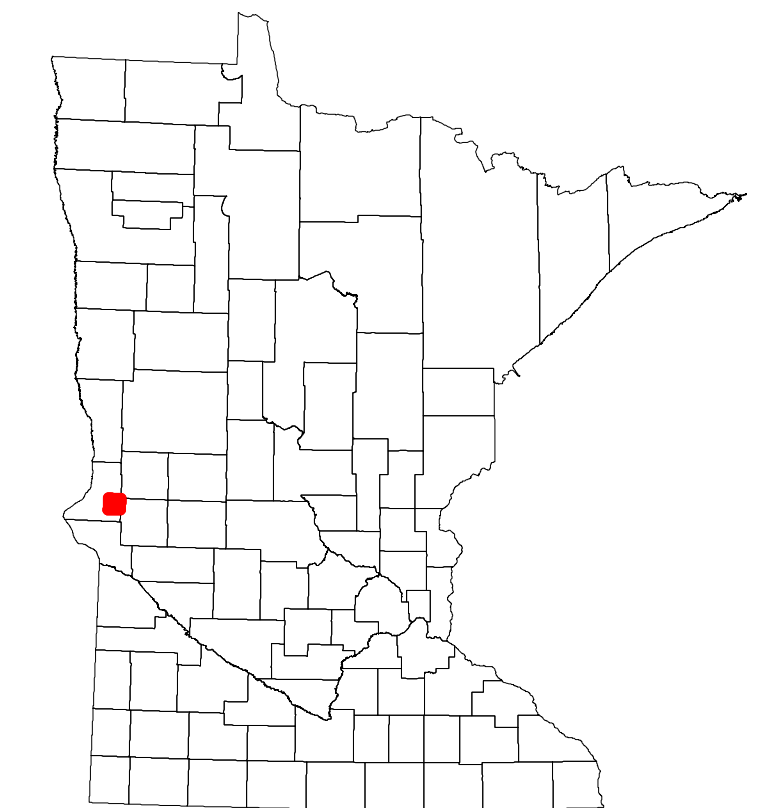

Population (U.S. Census 2010): 77

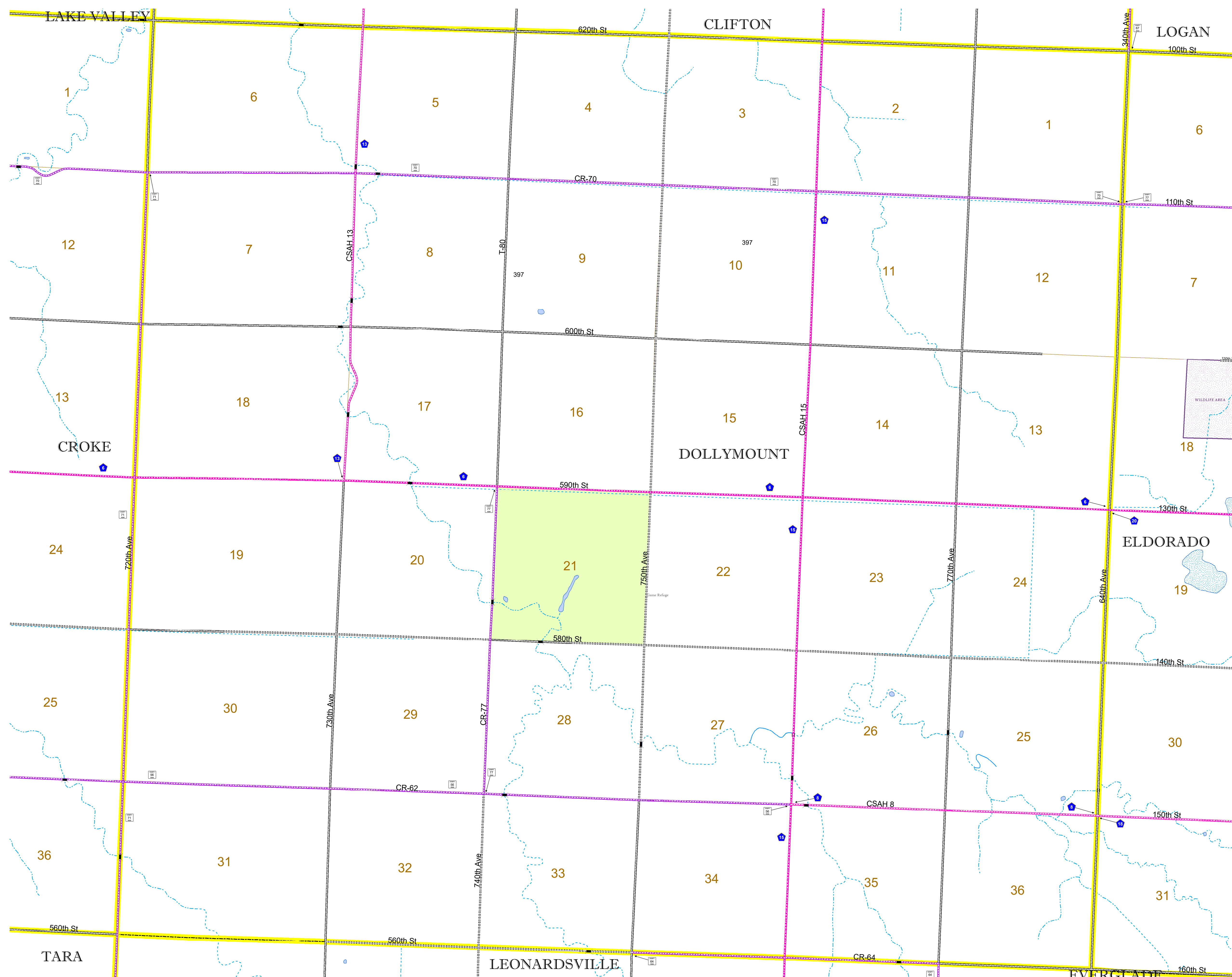

To request information from this document in an alternative format, call 651-366-4718 or 1-800-657-3774 (Greater Minnesota); 711 or 1-800-627-3529 (Minnesota Relay). You may also send an e-mail to ADarequest.dot@state.mn.us. (Please request at least one week in advance.)