

TOWNSHIP OF NORTHFIELD

PREPARED BY THE
MINNESOTA DEPARTMENT OF TRANSPORTATION
OFFICE OF TRANSPORTATION SYSTEM MANAGEMENT

IN COOPERATION WITH
U.S. DEPARTMENT OF TRANSPORTATION
FEDERAL HIGHWAY ADMINISTRATION

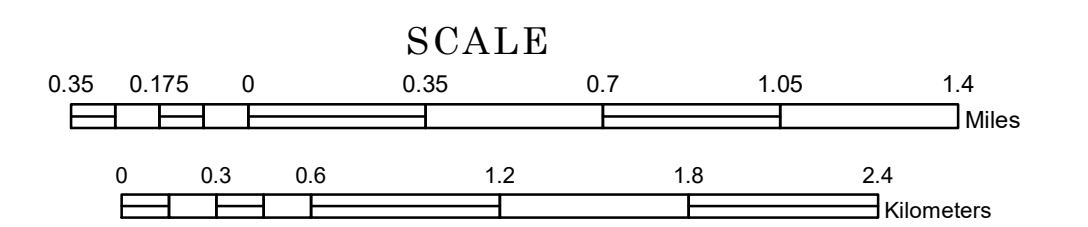

1 in = 2,000 ft

2024

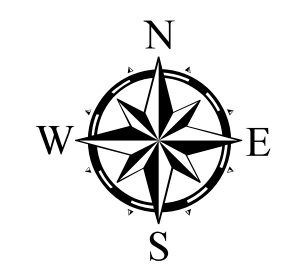

Projection:
Transverse Mercator
NAD 1986
UTM Zone 15

North American Datum
of 1986

ROAD AND ROADWAY FEATURES		BOUNDARY FEATURES	
INTERSTATE	CONCRETE	STATE OF MINNESOTA	SECTION
US HIGHWAY	BITUMINOUS	COUNTY	MILITARY
MN HIGHWAY	GRAVEL	MUNICIPALITY	VOYAGEURS NATIONAL PARK
COUNTY STATE AID HIGHWAY	DIRT/UNIMPROVED	UNINCORPORATED COMMUNITY	BOUNDARY WATERS GANOE AREA WILDERNESS
COUNTY ROAD	OTHER		STATE PARK
TOWNSHIP ROAD	UNKNOWN		NATIONAL FOREST
UNORGANIZED TERRITORY ROAD	RAMP OR CONNECTOR		NATIONAL AND STATE FOREST
OTHER ROADS	INTERSTATE EXIT		STATE FOREST
Municipal	GREAT RIVER ROAD		NATIONAL TRAIL
Private	AVIATION FEATURES		WILDLIFE REFUGUE AREA
National Monument	COMMERCIAL AIRPORT		WILDLIFE MANAGEMENT AREA
National Wildlife	GENERAL AIRPORT		HYDROLOGIC FEATURES
State Game	AIRSTRIP		RIVER OR STREAM (PERMANENT)
Muslim	SEAPLANE		LAKE, POND OR RESERVOIR
State Park	AIRPORT RUNWAY		STREAM (INTERMITTENT)
Present			DRAINAGE DITCH
RAILROAD AND RAILWAY FEATURES			WETLAND
EMPIRE BUILDER STATION (AMTRAK)			ISLAND OR LAND
NORTHSTAR STATION (COMPUTER)			REGIONAL WATERSHED
LIGHT RAIL			
BLUE LINE			
GREEN LINE			
INFRASTRUCTURE FEATURES			
LONG BRIDGE (200' OR GREATER SPAN)			
MAJOR BRIDGE (20' TO 200' SPAN)			
MINOR BRIDGE (5' TO 20' SPAN)			
DAM			
LOCK AND DAM			
CITY CENTERS			
STATE CAPITAL			
COUNTY SEAT			
CITY CENTER			
UNINCORPORATED COMMUNITY			
PUBLIC SERVICE FEATURES			
MNDOT OFFICE			
MNDOT TRUCK STATION			
HIGHWAY PATROL DISTRICT OFFICE			
STATE TRAVEL INFORMATION CENTER			
REST AREA (FULL SERVICE)			
REST AREA (VAULT TOILET)			
WAYSIDE (VAULT OR PIT TOILET)			
PARK AND RIDE LOT			
PORT OF ENTRY			
PUBLIC ACCESS POINT			
MN STATE COLLEGE AND UNIVERSITY SYSTEM (MNSCU)			
UNIVERSITY OF MN SYSTEM			
FAIRGROUNDS			
CULTURAL FEATURES			
STATE HISTORICAL MARKER			
HISTORIC DISTRICT			
HISTORIC SITE			
MONUMENT			

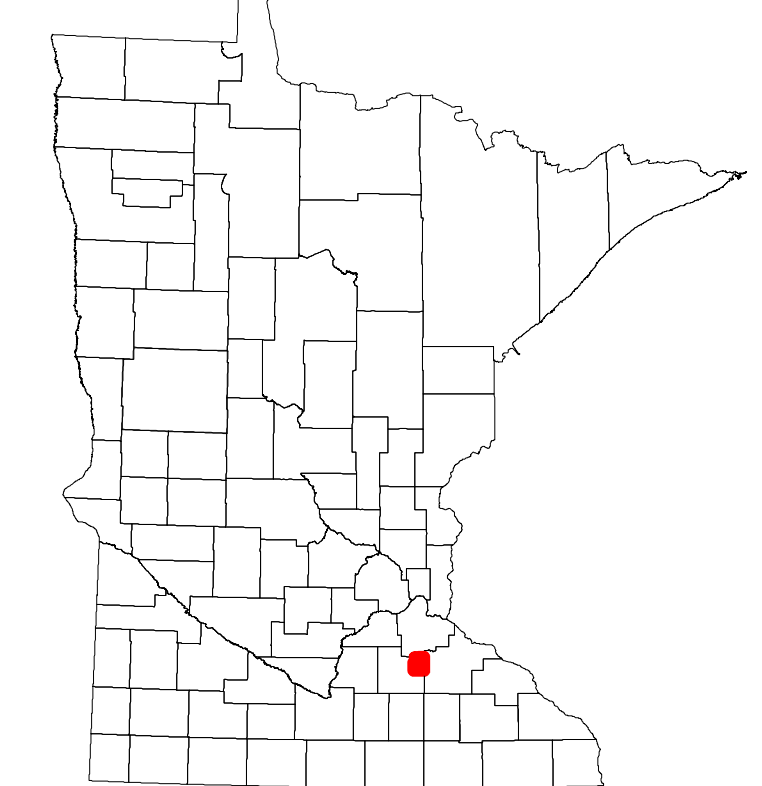

Population (U.S. Census 2010): 842

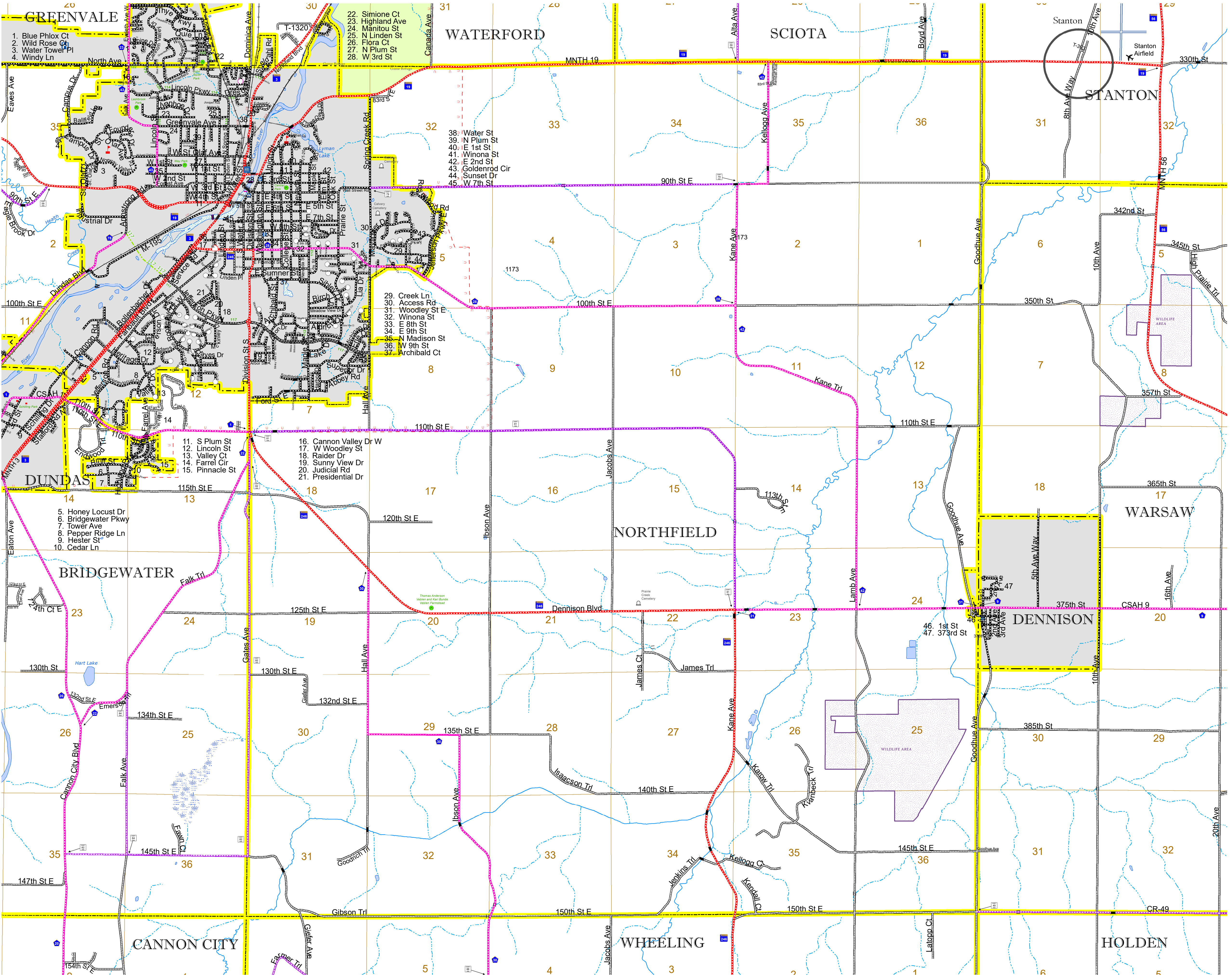

To request information from this document in an alternative format, call 651-366-4718 or 1-800-657-3774 (Greater Minnesota); 711 or 1-800-627-3529 (Minnesota Relay). You may also send an e-mail to ADARquest.dot@state.mn.us. (Please request at least one week in advance.)