

TOWNSHIP OF CONCORD

PREPARED BY THE
MINNESOTA DEPARTMENT OF TRANSPORTATION
OFFICE OF TRANSPORTATION SYSTEM MANAGEMENT

IN COOPERATION WITH
U.S. DEPARTMENT OF TRANSPORTATION
FEDERAL HIGHWAY ADMINISTRATION

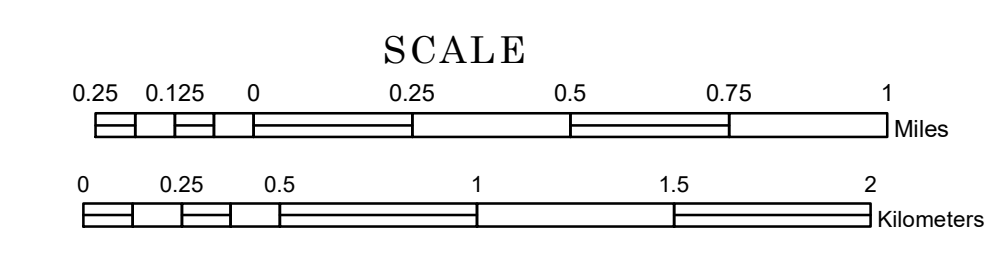

1 in = 1,600 ft
2024

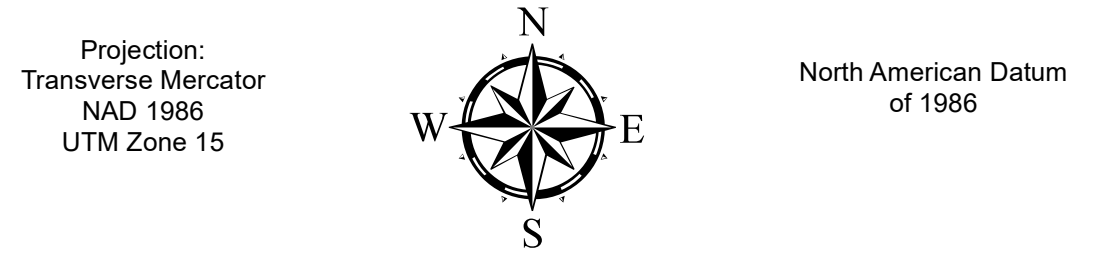

ROAD AND ROADWAY FEATURES		
INTERSTATE	CONCRETE	
US HIGHWAY	BITUMINOUS	
MN HIGHWAY	GRAVEL	
COUNTY STATE AID HIGHWAY	DIRT/UNIMPROVED	
COUNTY ROAD	OTHER	
TOWNSHIP ROAD	UNKNOWN	
UNORGANIZED TERRITORY ROAD	UNKNOWN	
OTHER ROADS	RAMP OR CONNECTOR	
Municipal	National Monument	State Forest
Native Service	National Park	State Game
Military	National Wildlife	State Park
	Preserve	
RAILROAD AND RAILWAY FEATURES		
EMPIRE BUILDER STATION (AMTRAK)	COMMERCIAL AIRPORT	
NORTHSTAR STATION (COMMUTER)	GENERAL AIRPORT	
LIGHT RAIL	AIRSTRIP	
BLUE LINE	SEAPLANE	
GREEN LINE	AIRPORT RUNWAY	
INFRASTRUCTURE FEATURES		
LONG BRIDGE (200' or Greater Span)	TRIBAL LAND	
MAJOR BRIDGE (20' to 200' Span)	STATE OF MINNESOTA	
MINOR BRIDGE (5' to 20' Span)	COUNTY	
DAM	MUNICIPALITY	
LOCK AND DAM	UNORGANIZED TERRITORY	
	FEDERAL ADJUSTED URBAN AREA (2014)	
	CIVIL TOWNSHIP	
	CONGRESSIONAL TOWNSHIP	
CITY CENTERS		
STATE CAPITAL	SECTION	
COUNTY SEAT	MILITARY	
CITY CENTER	VOYAGEURS NATIONAL PARK	
UNINCORPORATED COMMUNITY	BOUNDARY WATERS CANOE AREA WILDERNESS	
PUBLIC SERVICE FEATURES		
MN DOT OFFICE	STATE PARK	
MN DOT TRUCK STATION	REGIONAL PARK	
HIGHWAY PATROL DISTRICT OFFICE	NATIONAL FOREST	
STATE TRAVEL INFORMATION CENTER	NATIONAL AND STATE FOREST	
REST AREA (Full Service)	STATE FOREST	
REST AREA (Vault Toilet)	NATIONAL TRAIL	
WAYSIDE (Vault or Pit Toilet)	WILDLIFE REFUGUE AREA	
PARK AND RIDE LOT	WILDLIFE MANAGEMENT AREA	
PORT OF ENTRY	HYDROLOGIC FEATURES	
PUBLIC ACCESS POINT	RIVER OR STREAM (PERMANENT)	
MN STATE COLLEGE AND UNIVERSITY SYSTEM (MNSCU)	LAKE, POND OR RESERVOIR	
UNIVERSITY OF MN SYSTEM	STREAM (INTERMITTENT)	
FAIRGROUNDS	DRAINAGE DITCH	
CULTURAL FEATURES		
STATE HISTORICAL MARKER	WETLAND	
HISTORIC DISTRICT	ISLAND OR LAND	
HISTORIC SITE	REGIONAL WATERSHED	
MONUMENT		

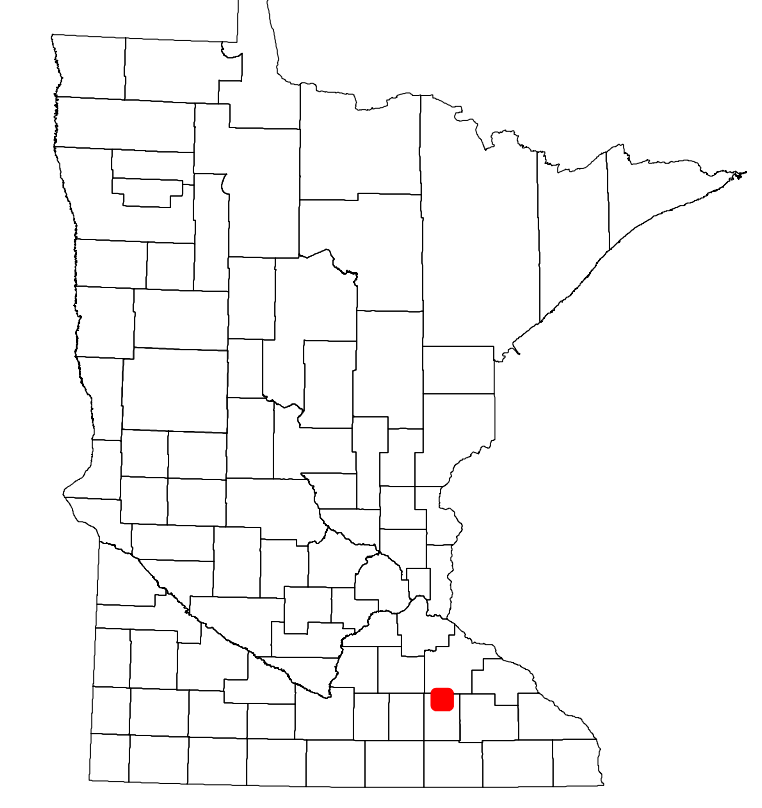

Population (U.S. Census 2010): 574

To request information from this document in an alternative format, call 651-366-4718 or 1-800-657-3774 (Greater Minnesota); 711 or 1-800-627-3529 (Minnesota Relay). You may also send an e-mail to ADRequest.dot@state.mn.us. (Please request at least one week in advance.)