

# MUNICIPALITIES OF MOWER CO.

PREPARED BY THE  
MINNESOTA DEPARTMENT OF TRANSPORTATION  
OFFICE OF TRANSPORTATION SYSTEM MANAGEMENT  
IN COOPERATION WITH  
U.S. DEPARTMENT OF TRANSPORTATION  
FEDERAL HIGHWAY ADMINISTRATION

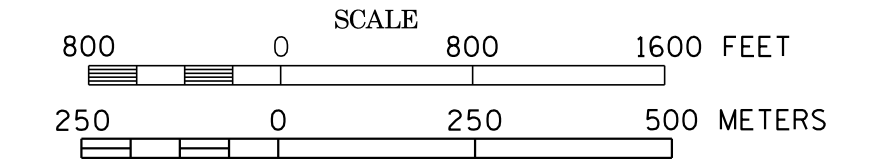

2015  
BASIC DATA - 2013

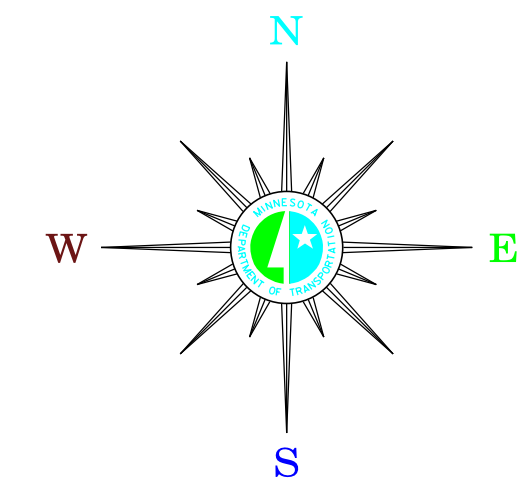

## LEGEND

- INTERSTATE TRUNK HIGHWAY..... (I-90)
- U.S. TRUNK HIGHWAY..... (16)
- STATE TRUNK HIGHWAY..... (56)
- COUNTY STATE AID HIGHWAY..... (14)
- COUNTY ROAD..... (10)
- PUBLIC ROAD.....
- PRIVATE ROAD.....
- CORPORATE LIMITS.....

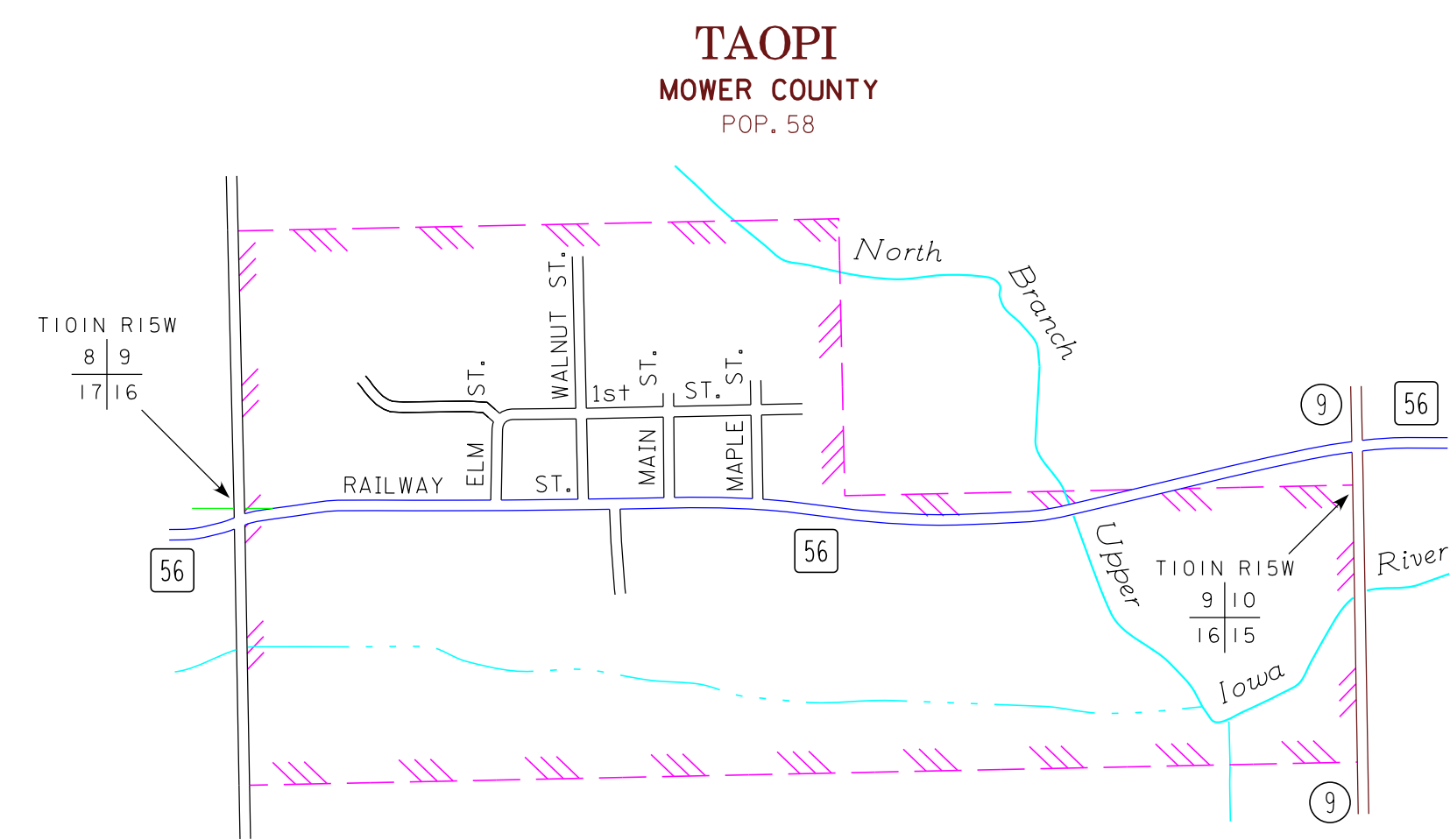
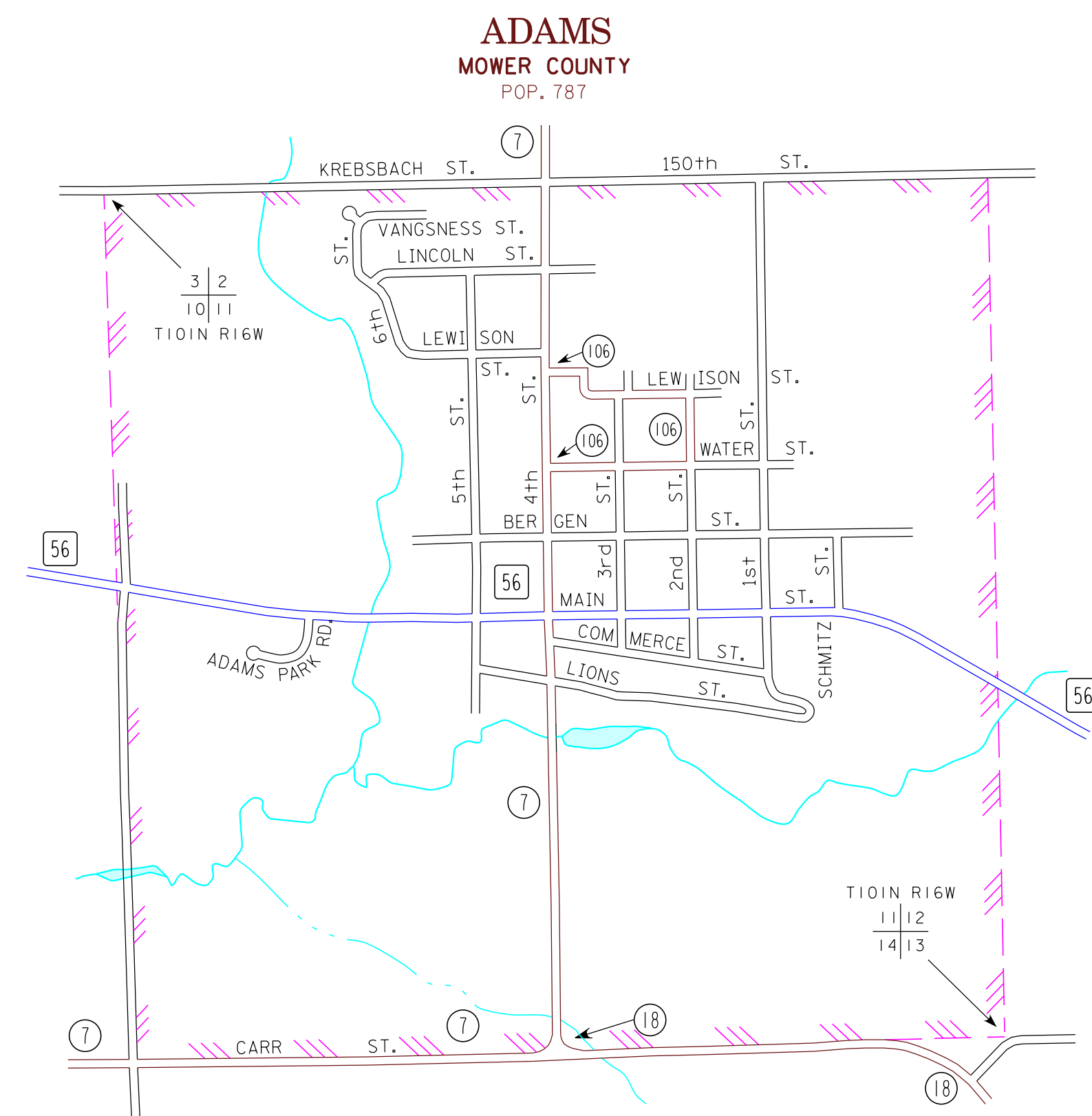
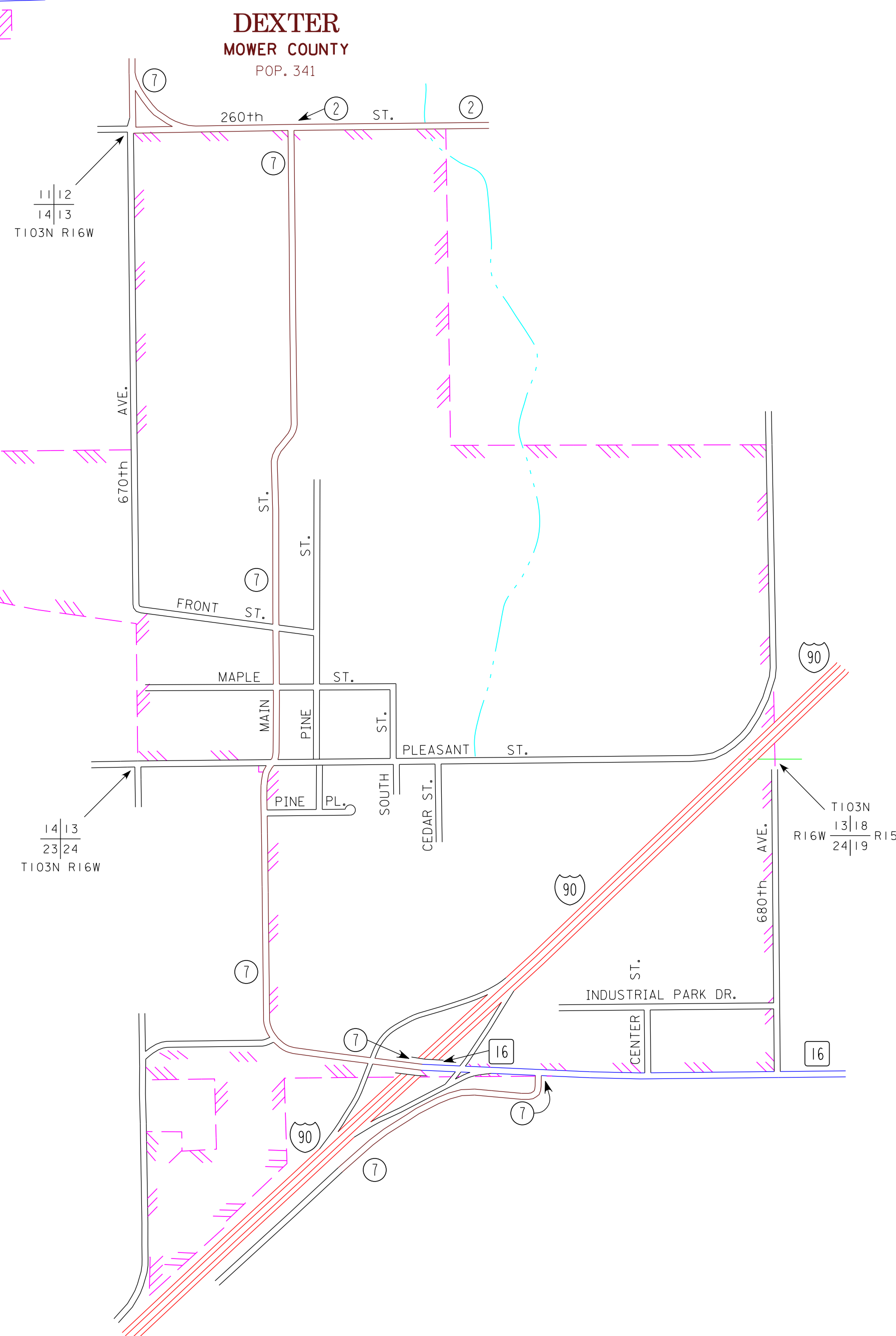
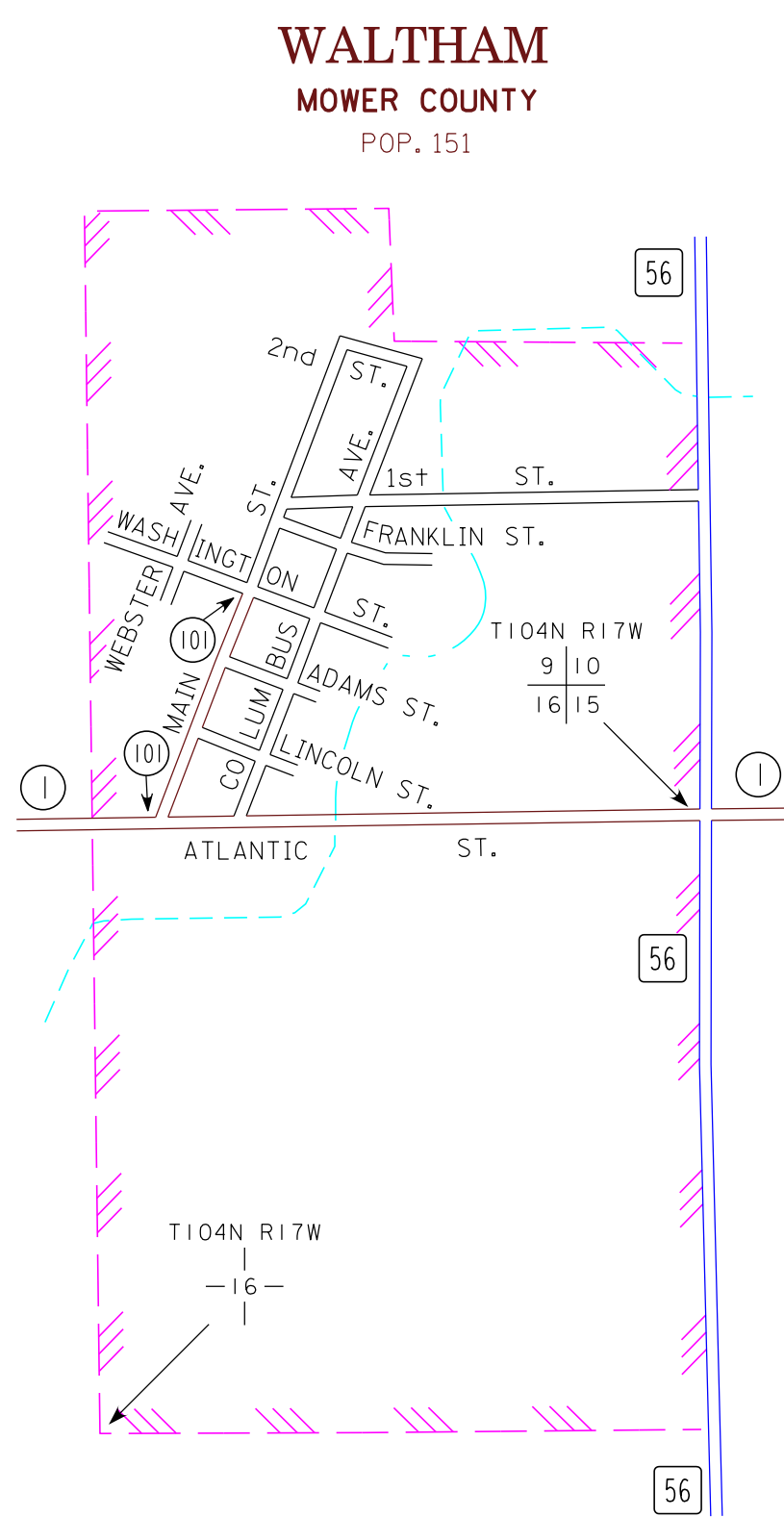
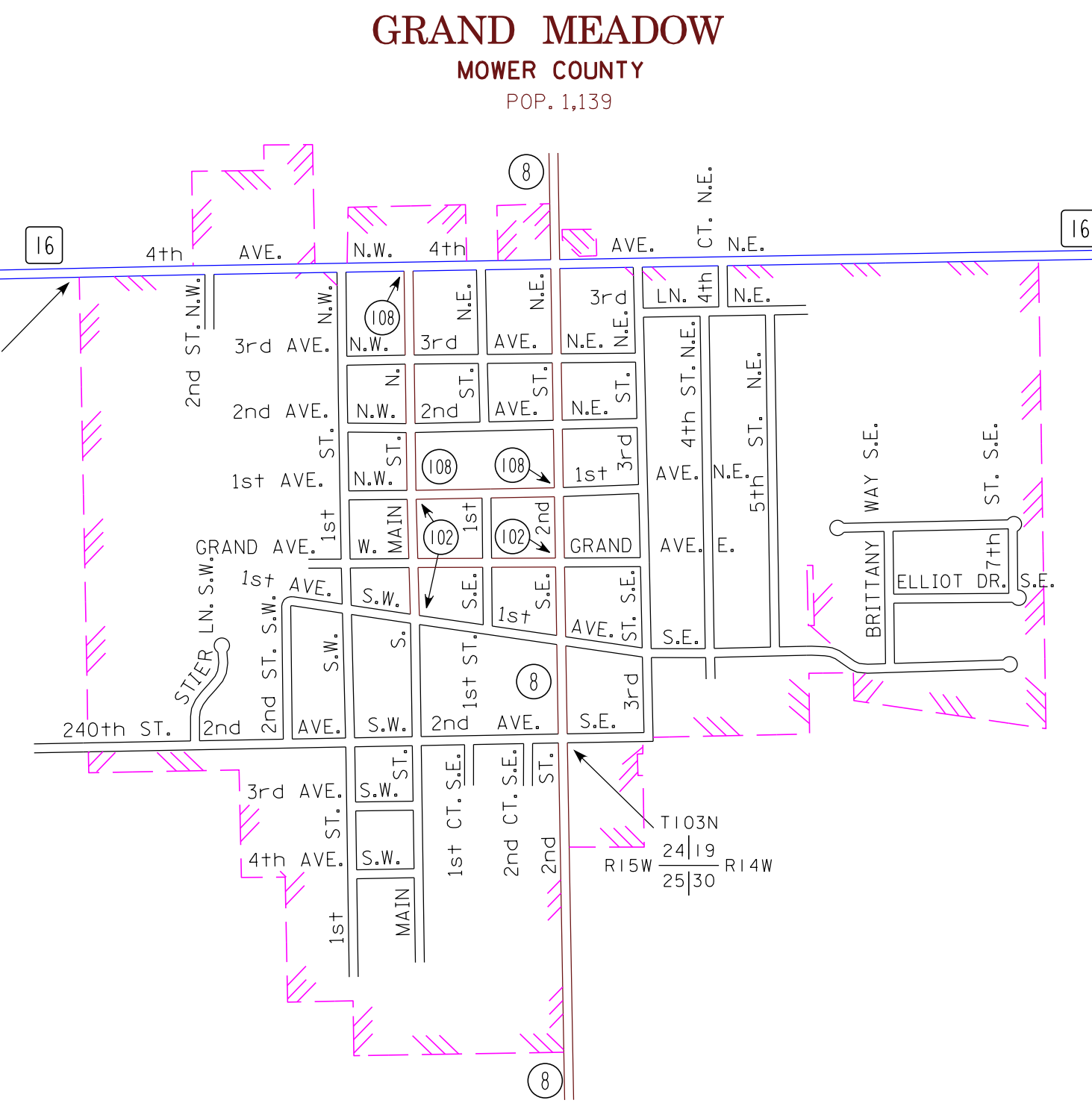
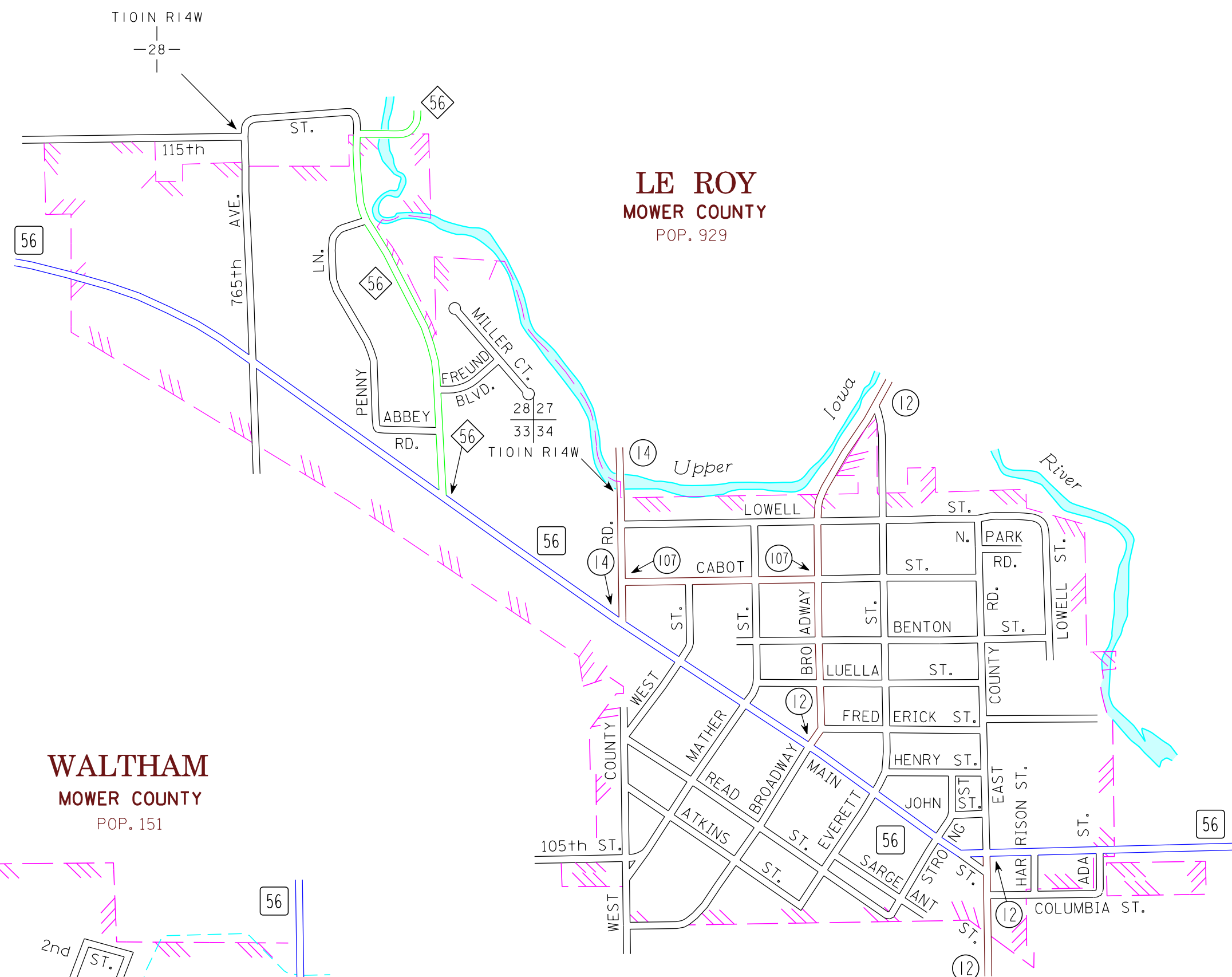

- MUNICIPALITIES SHOWN  
ON THIS SHEET
- ADAMS
  - DEXTER
  - GRAND MEADOW
  - LE ROY
  - TAOPI
  - WALTHAM

To request information from this document in an alternative format, call 651-366-4718 or 1-800-657-3774 (Greater Minnesota); 711 or 1-800-627-3529 (Minnesota Relay). You may also send an e-mail to [ADRequest.dnr@state.mn.us](mailto:ADRequest.dnr@state.mn.us). (Please request at least one week in advance).

NOTE: 2010 U.S. CENSUS FIGURES SHOWN FOR ALL MUNICIPALITIES UNLESS OTHERWISE STATED.