

28

27

MUNICIPALITY OF FELTON

PREPARED BY THE
MINNESOTA DEPARTMENT OF TRANSPORTATION
OFFICE OF TRANSPORTATION SYSTEM MANAGEMENT

IN COOPERATION WITH
U.S. DEPARTMENT OF TRANSPORTATION
FEDERAL HIGHWAY ADMINISTRATION

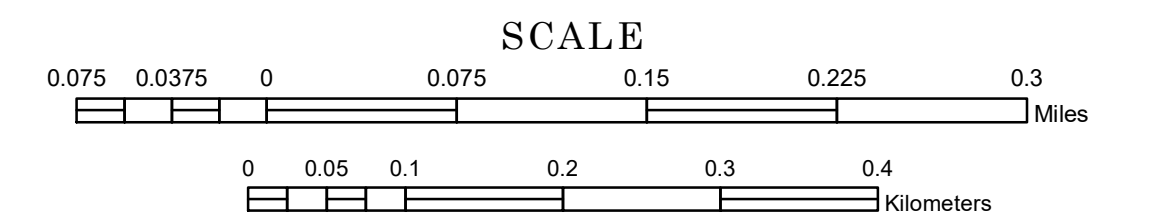

1 in = 400 ft

2023

Projection:
Transverse Mercator
NAD 1986
UTM Zone 15

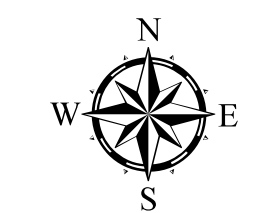

North American Datum
of 1986

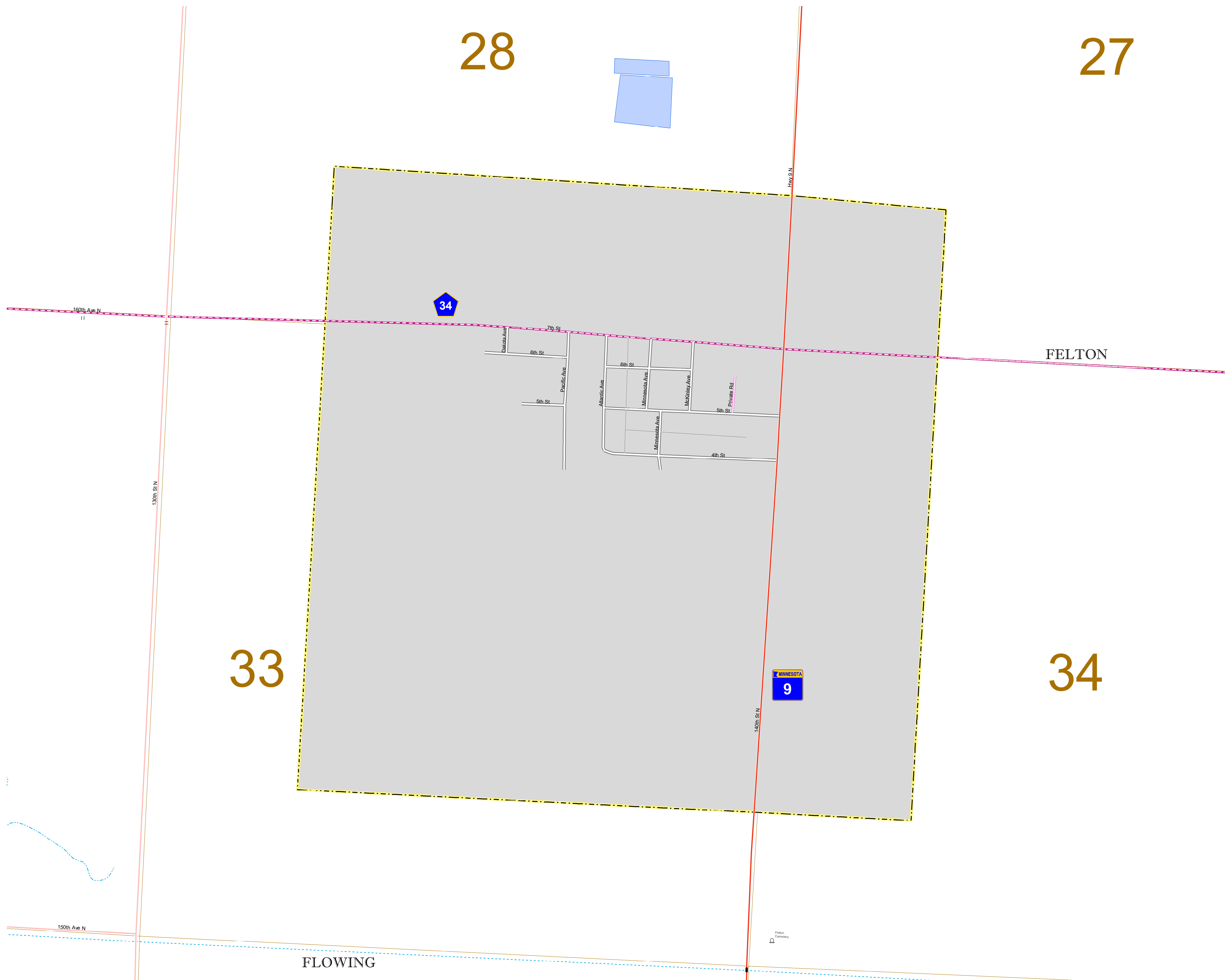

ROAD AND ROADWAY FEATURES		PUBLIC SERVICE FEATURES	
INTERSTATE		MINOT OFFICE	
US HIGHWAY		MINOT TRUCK STATION	
BN HIGHWAY		HIGHWAY PATROL DISTRICT OFFICE	
COUNTY STATE AID HIGHWAY		STATE TRAVEL INFORMATION CENTER	
COUNTY ROAD		REST AREA (Full Service)	
MUNICIPAL STREET		REST AREA (Quick Turn)	
MUNICIPAL STATE AID STREET		WAYSIDE (Only on Pk Trunk)	
PRIVATE STREET/ROAD		PUBLIC ACCESS POINT	
TOWNSHIP ROAD		LOCAL PARK	
UNORGANIZED TERRITORY ROAD		FARMS/GROUNDS	
RAMP OR CONNECTOR		PORT OF ENTRY	
GREAT RIVER ROAD		PARK AND RIDE LOT	
OTHER ROADS		PUBLIC UNIVERSITY/COLLEGE	
FARMROAD		PRIVATE UNIVERSITY/COLLEGE	
STATE PARK		ELEMENTARY SCHOOL	
NATIONAL PARK		MIDDLE SCHOOL	
MONUMENT		HIGH SCHOOL	
STATE FOREST			
NATIONAL FOREST			
NATIONAL WILDLIFE STATE GAME			
RAILROAD AND RAILWAY FEATURES		AVIATION FEATURES	
RAILWAY		COMMERCIAL AIRPORT	
EMPIRE BUILDER STATION (AMTRAK)		GENERAL AIRPORT	
NORTHSTAR STATION (COMASTER)		AIRSTRIP	
LIGHT RAIL		SEAPLANE	
BLUE LINE STATION		AIRPORT RUNWAY	
GREEN LINE STATION			
INFRASTRUCTURE FEATURES		CULTURAL FEATURES	
LONG BRIDGE (100' OR GREATER SPAN)		STATE HISTORICAL MARKER	
MAJOR BRIDGE (20' TO 100' SPAN)		HISTORIC DISTRICT	
MINOR BRIDGE (2' TO 20' SPAN)		HISTORIC SITE	
ROAD TUNNEL (100' OR GREATER SPAN)		MONUMENT	
RAILROAD BRIDGE (100' OR GREATER SPAN)		CEMETERY	
RAILROAD BRIDGE (LESSER 100' SPAN)			
SKYWAY		BOUNDARY FEATURES	
PEDESTRIAN BRIDGE		TRIBAL LAND	
PEDESTRIAN TUNNEL		COUNTY	
DAM		MUNICIPALITY	
LOCK AND DAM		ADJACENT MUNICIPALITY	
		FEDERAL ADJUSTED URBAN AREA (2014)	
PUBLIC FACILITIES		MILITARY	
STATE CAPITOL		STATE PARK	
FEDERAL COURTHOUSE		REGIONAL PARK	
COUNTY COURTHOUSE		NATIONAL FOREST	
ARMORY		NATIONAL AND STATE FOREST	
CITY HALL		STATE FOREST	
TOWN HALL		NATIONAL TRAIL	
COMMUNITY CENTER		WILDLIFE REFUGE AREA	
ARENA		WILDLIFE MANAGEMENT AREA	
STADIUM			
POST OFFICE		HYDROLOGIC FEATURES	
POLICE STATION		RIVER OR STREAM (PERMANENT)	
FIRE STATION		LAKE, POND OR RESERVOIR	
PUBLIC LIBRARY		STREAM (PERMANENT)	
PUBLIC MUSEUM		DRAINAGE DITCH	
EVENT CENTER			
CITY CENTERS		WETLAND	
TRIBAL GOVERNMENT CENTER		ISLAND OR LAND	
CITY CENTER		REGIONAL WATERSHED	
LOCALLY INCORPORATED PLACE			
UNINCORPORATED COMMUNITY			

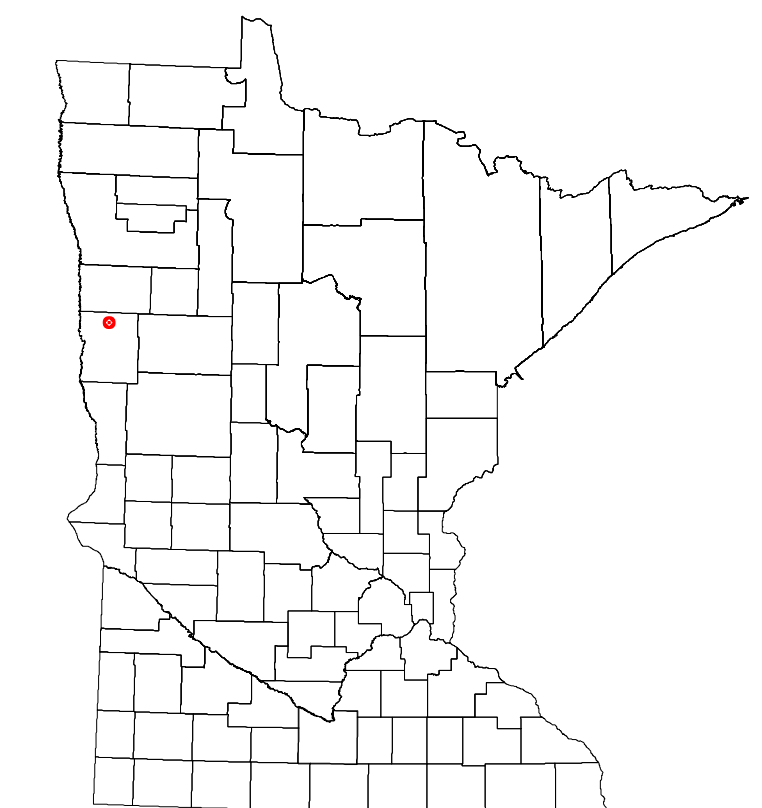

FLOWING

LAST EDITED ON 12-10-2023

Population (U.S. Census 2020): 177

To request information from this document in an alternative format, call 651-366-4718 or 1-800-657-3774 (Greater Minnesota); 711 or 1-800-627-3529 (Minnesota Relay). You may also send an e-mail to ADRequest.dot@state.mn.us. (Please request at least one week in advance.)