

# BICYCLE MAP REDWOOD COUNTY MINNESOTA

PREPARED BY THE  
MINNESOTA DEPARTMENT OF TRANSPORTATION  
OFFICE OF TRANSPORTATION SYSTEM MANAGEMENT

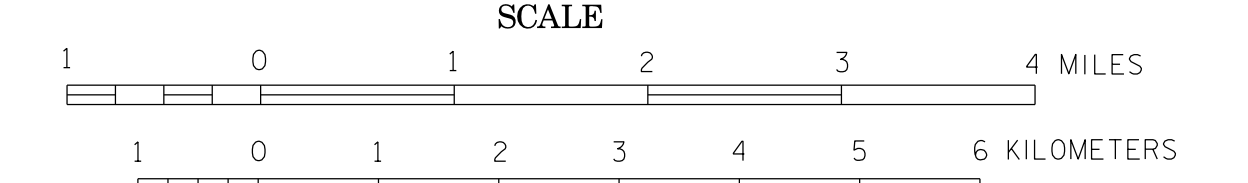

2016  
BASIC DATA - 2015

Projection:  
Minnesota Coordinate System  
South Zone  
Lambert Conformal Conic

North American Datum  
of 1983

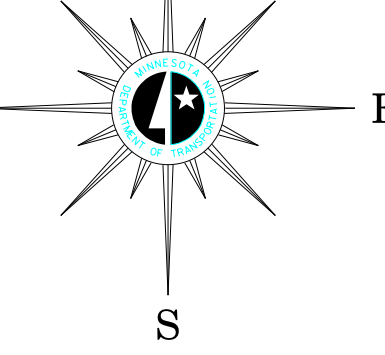

## LEGEND

- |  |   |
|--|---|
| (Roadways with shoulders less than 4 feet) | (Roadways with shoulders greater than 4 feet) |
| 0-750 (fewer than 3 cars / min)            | 751-2000 (3 cars / min)                       |
| 751-2000 (3 cars / min)                    | 2001-10,000 (12 cars / min)                   |
| 2001-10,000 (12 cars / min)                | 10,000+ (24+ cars / min)                      |
| Gravel Roadway                             | Federal, State and Regional Bicycle Trails    |
| Mississippi River Trail                    | Interstate / Bicycles Prohibited              |
| State or National Forests                  |   |

## ROAD AND ROADWAY FEATURES

- PROJECTED ROAD
- PRIMITIVE ROAD
- UNIMPROVED ROAD
- GRADED AND DRAINED ROAD
- SOIL SURFACE ROAD
- GRAVEL OR STONE ROAD
- BITUMINOUS ROAD
- PAVED ROAD
- DIVIDED ROAD
- TRUNK HIGHWAY UNDER CONSTRUCTION
- ROADS IN UNINCORPORATED COMPACTS, EXTENSIONS OF LOCAL ROADS, NOT F.A.S.S. WITHIN MUNICIPALITIES AND FRONTAGE ROADS
- GRADE SEPARATION
- FULL TRAFFIC INTERCHANGE
- PARTIAL TRAFFIC INTERCHANGES INDICATING TRAFFIC MOVEMENT

## ROAD SYSTEM DESIGNATIONS

- INTERSTATE TRUNK HIGHWAY
- U.S. NUMBERED TRUNK HIGHWAY
- STATE NUMBERED TRUNK HIGHWAY
- COUNTY STATE AID HIGHWAY
- COUNTY ROAD
- COUNTY STATE AID IN ADJOINING COUNTY
- TERMINATION OF DESIGNATED ROUTE

## BOUNDARIES

- NATIONAL OR STATE
- COUNTY
- CIVIL TOWNSHIP
- CONGRESSIONAL TOWNSHIP (U.S. LAND)
- CORPORATE LINE
- SECTION LINE
- CONGESTED AREA
- INDIAN RESERVATION

## DRAINAGE

- INTERMITTENT STREAM
- NARROW STREAM
- WIDE STREAMS
- MARSH OR SWAMP LAND
- DRAINAGE DITCH
- LAKE OR POND

## CITY CENTERS

- STATE CAPITAL
- COUNTY SEAT
- CITY CENTER
- INCORPORATED CITY (GENERALIZED)

Outline Map of Minnesota showing location of the County within the State.

Outline Map of the County. Shaded portion is area depicted on this sheet. Area of this County 885 Sq. Miles. Land Area 885 Sq. Miles. 2000 Total County Population 16,059

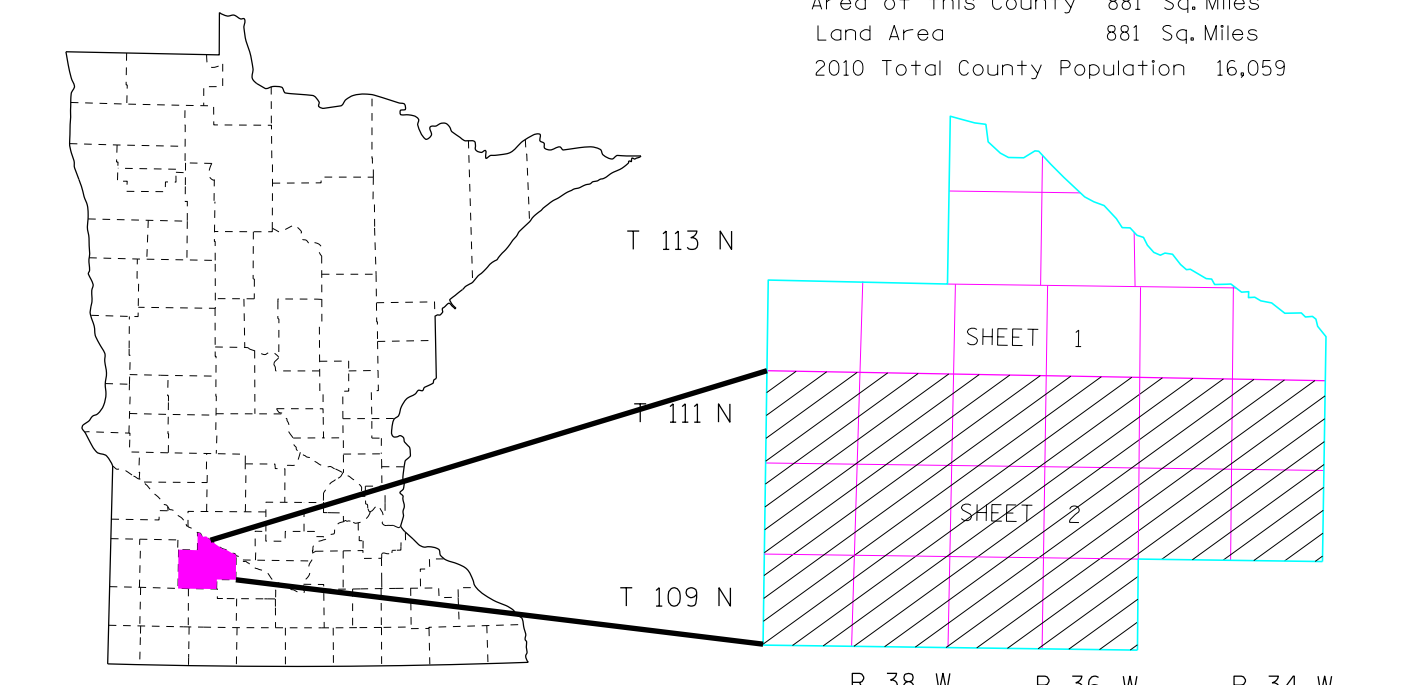

To request information from this document in an alternative format, call 612-366-4718 or 1-800-657-3774 (Greater Minnesota), 711 or 1-800-627-3529 (Minnesota Relay). You may also send an e-mail to [AGIrequest@dot.state.mn.us](mailto:AGIrequest@dot.state.mn.us). (Please request at least one week in advance).

NOTE: FOR DETAIL OF COUNTY STATE AID HIGHWAYS AND COUNTY ROADS IN INCORPORATED PLACES, SEE MAPS OF MUNICIPALITIES.