

BICYCLE MAP REDWOOD COUNTY MINNESOTA

PREPARED BY THE
MINNESOTA DEPARTMENT OF TRANSPORTATION
OFFICE OF TRANSPORTATION SYSTEM MANAGEMENT

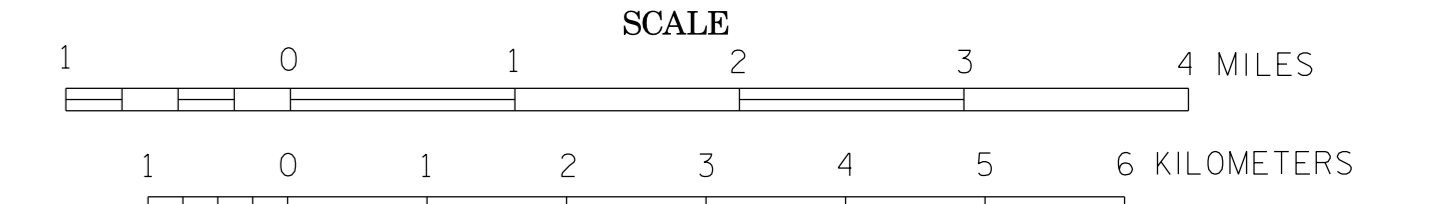

2016
BASIC DATA - 2015

Projection:
Minnesota Coordinate System
South Zone
Lambert Conformal Conic
North American Datum
of 1983

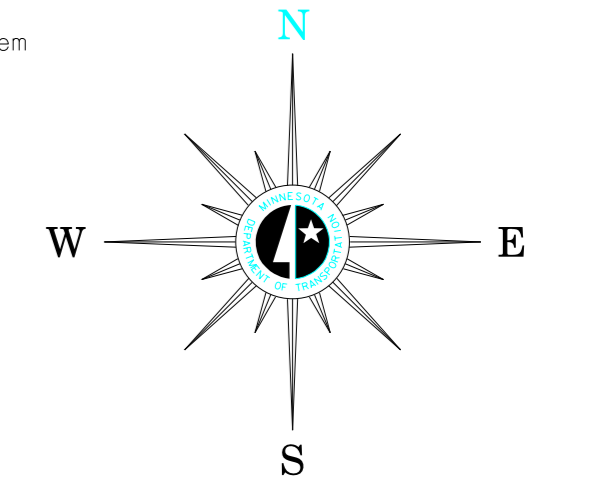

LEGEND

(Roadways with shoulders less than 4 feet)	(Roadways with shoulders greater than 4 feet)
0-750 (Fewer than 3 cars / min)	751-2500 (3 cars / min)
751-2500 (3 cars / min)	2501-10,000 (12 cars / min)
2501-10,000 (12 cars / min)	10,000+ (24+ cars / min)
Gravel Roadway	Federal, State and Regional Bicycle Trails
Mississippi River Trail	Interstates / Bicycles Prohibited
State or National Forests	

ROAD AND ROADWAY FEATURES

PROJECTED ROAD
PRIMITIVE ROAD
UNIMPROVED ROAD
GRADED AND DRAINED ROAD
SOIL SURFACE ROAD
GRAVEL OR STONE ROAD
BITUMINOUS ROAD
PAVED ROAD
DIVIDED ROAD
TRUNK HIGHWAY UNDER CONSTRUCTION
ROADS IN UNINCORPORATED COMPACTS, EXTENSIONS OF LOCAL ROADS (NOT F.A.S.J. WITHIN MUNICIPALITIES AND FRONTAGE ROADS)
GRADE SEPARATION
FULL TRAFFIC INTERCHANGE
PARTIAL TRAFFIC INTERCHANGES INDICATING TRAFFIC MOVEMENT

ROAD SYSTEM DESIGNATIONS

INTERSTATE TRUNK HIGHWAY
U.S. NUMBERED TRUNK HIGHWAY
STATE NUMBERED TRUNK HIGHWAY
COUNTY STATE AID HIGHWAY
COUNTY ROAD
COUNTY STATE AID IN ADJOINING COUNTY
TERMINATION OF DESIGNATED ROUTE

BOUNDARIES

NATIONAL OR STATE
COUNTY
CIVIL TOWNSHIP
CONGRESSIONAL TOWNSHIP (U.S. LAND)
CORPORATE LINE
SECTION LINE
CONGESTED AREA
INDIAN RESERVATION

DRAINAGE

INTERMITTENT STREAM
NARROW STREAM
WIDE STREAMS
MARSH OR SWAMP LAND
DRAINAGE DITCH
LAKE OR POND

CITY CENTERS

STATE CAPITAL
COUNTY SEAT
CITY CENTER
INCORPORATED CITY (GENERALIZED)

Outline Map of Minnesota showing location of the County within the State. Shaded portion is area delineated on this sheet.
Area of this County: 881 Sq. Miles
Land Area: 881 Sq. Miles
2010 Total County Population: 16,059

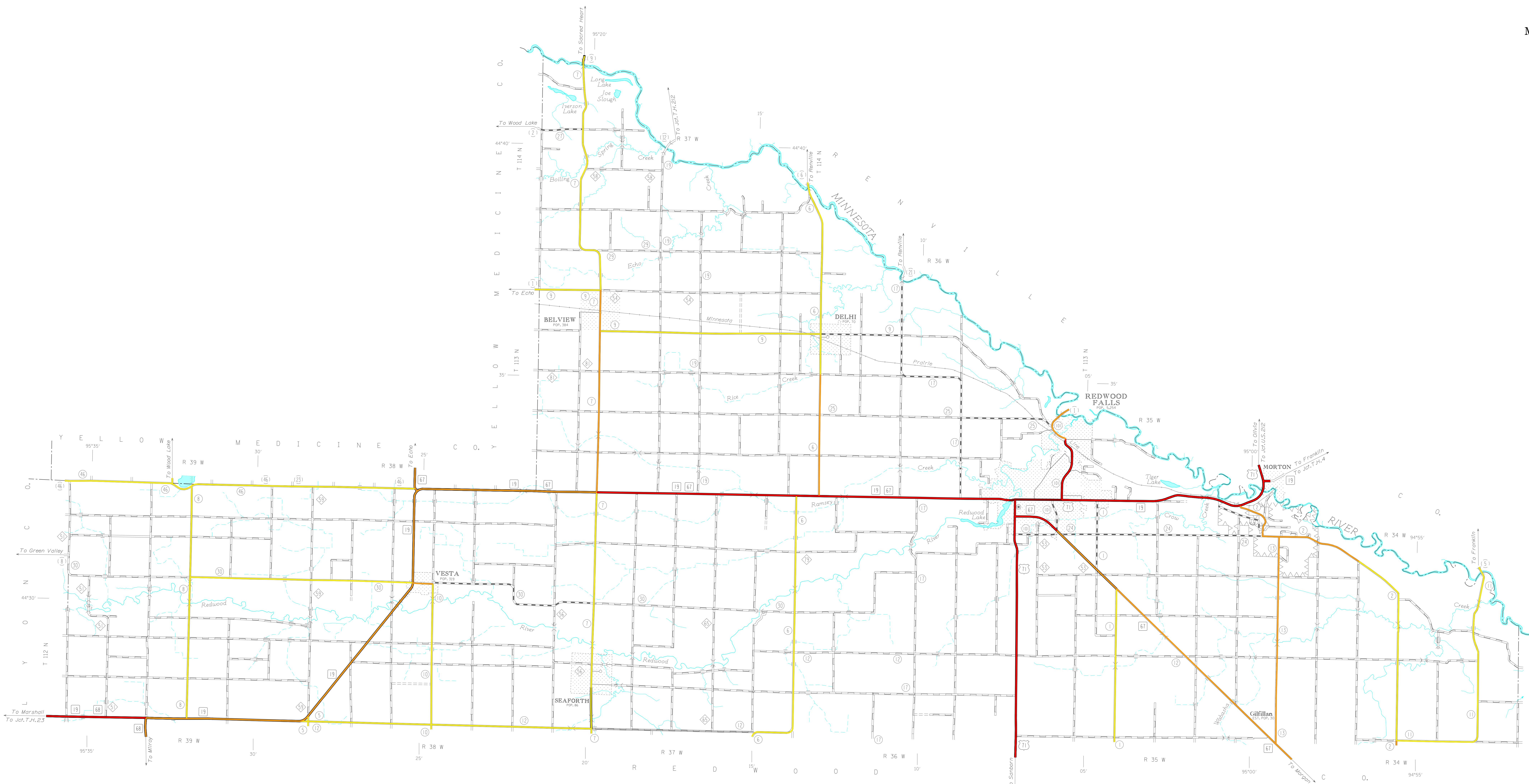
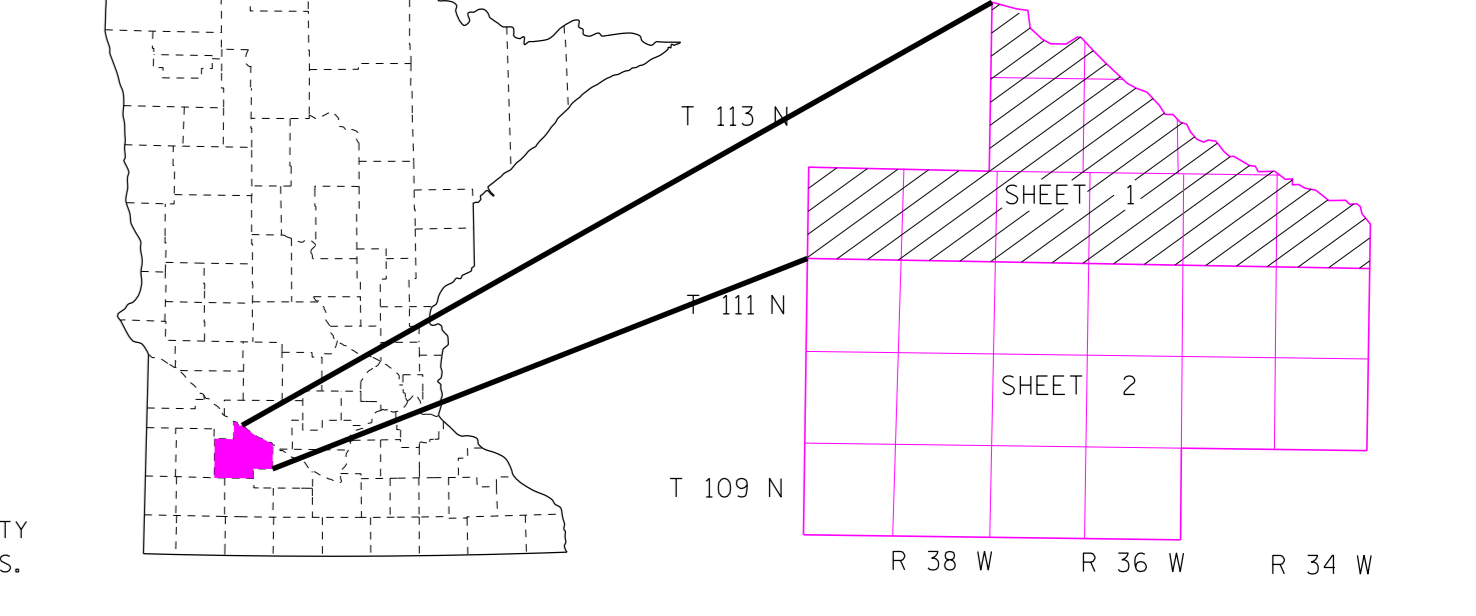

To request information from this document in an alternative format, call 651-366-4716 or 1-800-657-3774 (Greater Minnesota); 711 or 1-800-627-3539 (Minnesota Relay). You may also send an e-mail to ADAtrequest.dor@state.mn.us. (Please request at least one week in advance.)

NOTE: FOR DETAIL OF COUNTY STATE AID HIGHWAYS AND COUNTY ROADS IN INCORPORATED PLACES, SEE MAPS OF MUNICIPALITIES.