

BICYCLE MAP MILLE LACS COUNTY MINNESOTA

PREPARED BY THE
MINNESOTA DEPARTMENT OF TRANSPORTATION
OFFICE OF TRANSPORTATION SYSTEM MANAGEMENT

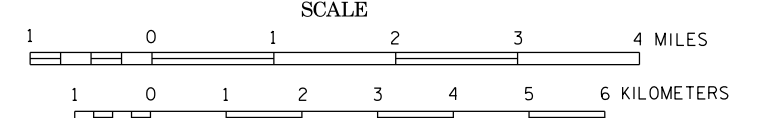

2016

BASIC DATA - 2015

Projections
Minnesota Coordinate System
Central Zone
Lambert Conformal Conic

North American Datum
of 1983

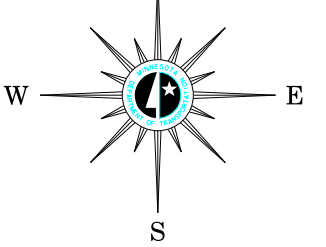

- | | | |
|--|--|---|
| (Roadways with shoulders less than 4 feet) | 0 - 750 (Fewer than 3 cars / min) | (Roadways with shoulders greater than 4 feet) |
| (Yellow line) | 751 - 2500 (3 cars / min) | (Orange line) |
| (Orange line) | 2501 - 10,000 (12 cars / min) | (Red line) |
| (Red line) | 10,000+ (24+ cars / min) | (Dark red line) |
| (Green line) | Gravel Roadway | (Green line) |
| (Blue line) | Federal, State and Regional Bicycle Trails | (Blue line) |
| (Purple line) | Mississippi River Trail | (Purple line) |
| (Pink line) | Interstate / Bicycles Prohibited | (Pink line) |
| (Light green area) | State or National Forests | (Light green area) |

ROAD AND ROADWAY FEATURES

- | | |
|--|--------------------------------------|
| PROJECTED ROAD | (Dashed line) |
| PRIMITIVE ROAD | (Dotted line) |
| UNIMPROVED ROAD | (Dashed line with dots) |
| GRADED AND DRAINED ROAD | (Line with parallel dashes) |
| SOIL SURFACE ROAD | (Line with diagonal dashes) |
| GRAVEL OR STONE ROAD | (Line with cross-hatch) |
| BITUMINOUS ROAD | (Line with wavy dashes) |
| PAVED ROAD | (Line with solid dashes) |
| DIVIDED ROAD | (Line with double dashes) |
| TRUNK HIGHWAY UNDER CONSTRUCTION | (Line with diagonal dashes and dots) |
| ROADS IN UNINCORPORATED COMPACTS, EXTENSIONS OF LOCAL ROADS INTO F.A.S.I. WITHIN MUNICIPALITIES AND FRONTAGE ROADS | (Line with wavy dashes and dots) |
| GRADE SEPARATION | (Line with vertical bars) |
| FULL TRAFFIC INTERCHANGE | (Line with vertical bars and dots) |
| PARTIAL TRAFFIC INTERCHANGES | (Line with vertical bars and dots) |
| INDICATING TRAFFIC MOVEMENT | (Line with vertical bars and dots) |

ROAD SYSTEM DESIGNATIONS

- | | |
|--------------------------------------|------------------|
| INTERSTATE TRUNK HIGHWAY | (Shield with 35) |
| U.S. NUMBERED TRUNK HIGHWAY | (Shield with 65) |
| STATE NUMBERED TRUNK HIGHWAY | (Shield with 18) |
| COUNTY STATE AID HIGHWAY | (Shield with 5) |
| COUNTY ROAD | (Shield with 12) |
| COUNTY STATE AID IN ADJOINING COUNTY | (Shield with 24) |
| TERMINATION OF DESIGNATED ROUTE | (Shield with 34) |

BOUNDARIES

- | | |
|------------------------------------|-----------------------|
| NATIONAL OR STATE | (Dashed line) |
| COUNTY SEAT | (Circle with star) |
| CITY CENTER | (Circle with dot) |
| CIVIL TOWNSHIP | (Dotted line) |
| CONGRESSIONAL TOWNSHIP (U.S. LAND) | (Dotted line) |
| CORPORATE LINE | (Dotted line) |
| SECTION LINE | (Dotted line) |
| CONGESTED AREA | (Line with triangles) |
| INDIAN RESERVATION | (Line with triangles) |

DRAINAGE

- | | |
|---------------------|-------------|
| INTERMITTENT STREAM | (Wavy line) |
| NARROW STREAM | (Wavy line) |
| WIDE STREAMS | (Wavy line) |
| MARSH OR SWAMP LAND | (Wavy line) |
| DRAINAGE DITCH | (Wavy line) |
| LAKE OR POND | (Wavy line) |

CITY CENTERS

- | | |
|---------------------------------|--------------------|
| STATE CAPITAL | (Star in circle) |
| COUNTY SEAT | (Circle with star) |
| CITY CENTER | (Circle with dot) |
| INCORPORATED CITY (GENERALIZED) | (Circle with dot) |

Outline Map of Minnesota showing location of the County within the State.

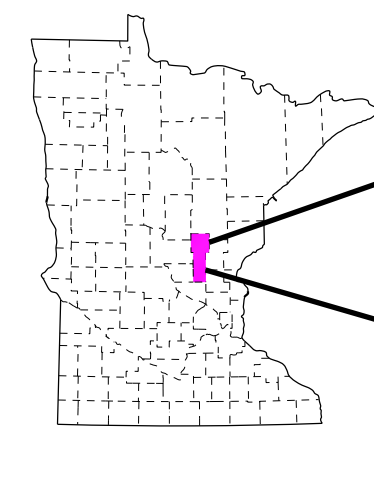

Outline Map of the County.

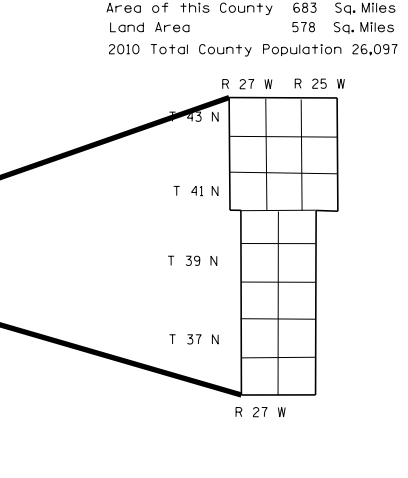

To request information from this document in an alternative format, call 651-366-4718 or 1-800-657-3774 (Greater Minnesota); 711 or 1-800-657-3639 (Minnesota Relay). You may also send an e-mail to ADRequest.dot@state.mn.us, please request at least one week in advance.

*NOTE: ALL FEATURES EXCEPT TOWNSHIP ROADS AND CULTURE ARE CURRENT AS OF JANUARY 1, 2015.
NOTE: FOR DETAIL OF COUNTY STATE AID HIGHWAYS AND COUNTY ROADS IN INCORPORATED PLACES, SEE MAPS OF MUNICIPALITIES.