

C A N A D A O N T A R I O

BICYCLE MAP KOOCHICING COUNTY MINNESOTA

PREPARED BY THE
MINNESOTA DEPARTMENT OF TRANSPORTATION
OFFICE OF TRANSPORTATION SYSTEM MANAGEMENT

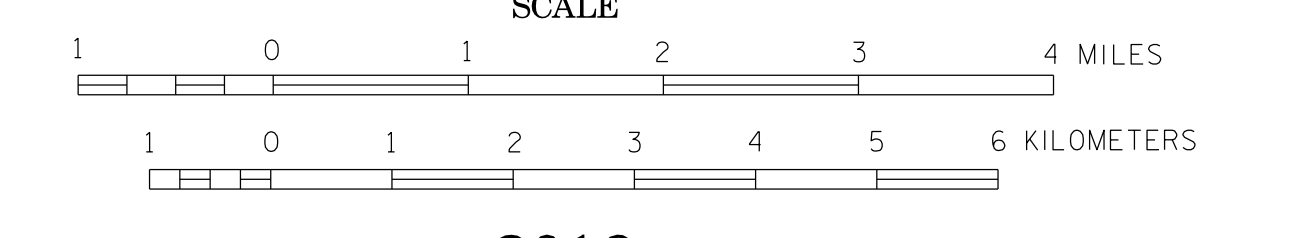

2016
BASIC DATA - 2015

Projection:
Minnesota Coordinate System
North Zone
Lambert Conformal Conic

North American Datum
of 1983

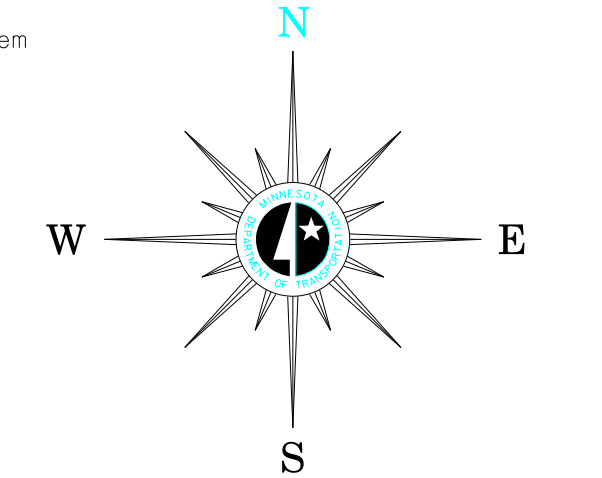

LEGEND

(Roadways with shoulders less than 4 feet)	(Roadways with shoulders greater than 4 feet)
0-750 (Fewer than 3 cars / min)	751-2500 (3 cars / min)
2501-10,000 (12 cars / min)	10,000+ (24+ cars / min)
Gravel Roadway	Federal, State and Regional Bicycle Trails
Mississippi River Trail	Interstate / Bicycles Prohibited
State or National Forests	

ROAD AND ROADWAY FEATURES

PROJECTED ROAD	PRIMITIVE ROAD
UNIMPROVED ROAD	GRAVEL AND DRAINED ROAD
SOIL SURFACE ROAD	GRAVEL OR STONE ROAD
BITUMINOUS ROAD	PAVED ROAD
DIVIDED ROAD	TRUNK HIGHWAY UNDER CONSTRUCTION
ROADS IN UNINCORPORATED COMPACTS, EXTENSIONS OF LOCAL ROADS (NOT F.A.S. WITHIN MUNICIPALITIES AND FRONTAGE ROADS)	GRADE SEPARATION
FULL TRAFFIC INTERCHANGE	PARTIAL TRAFFIC INTERCHANGES INDICATING TRAFFIC MOVEMENT

ROAD SYSTEM DESIGNATIONS

INTERSTATE TRUNK HIGHWAY	U.S. NUMBERED TRUNK HIGHWAY	STATE NUMBERED TRUNK HIGHWAY	COUNTY STATE AID HIGHWAY	COUNTY ROAD	COUNTY STATE AID IN ADJOINING COUNTY	TERMINATION OF DESIGNATED ROUTE
--------------------------	-----------------------------	------------------------------	--------------------------	-------------	--------------------------------------	---------------------------------

BOUNDARIES

NATIONAL OR STATE	COUNTY	CIVIL TOWNSHIP	CONGRESSIONAL TOWNSHIP (U.S. LAND)	CORPORATE LINE	SECTION LINE	CONGESTED AREA	INDIAN RESERVATION
-------------------	--------	----------------	------------------------------------	----------------	--------------	----------------	--------------------

DRAINAGE

INTERMITTENT STREAM	NARROW STREAM	WIDE STREAMS	MARSH OR SWAMP LAND	DRAINAGE DITCH	LAKE OR POND
---------------------	---------------	--------------	---------------------	----------------	--------------

CITY CENTERS

STATE CAPITAL	COUNTY SEAT	CITY CENTER	INCORPORATED CITY (GENERALIZED)
---------------	-------------	-------------	---------------------------------

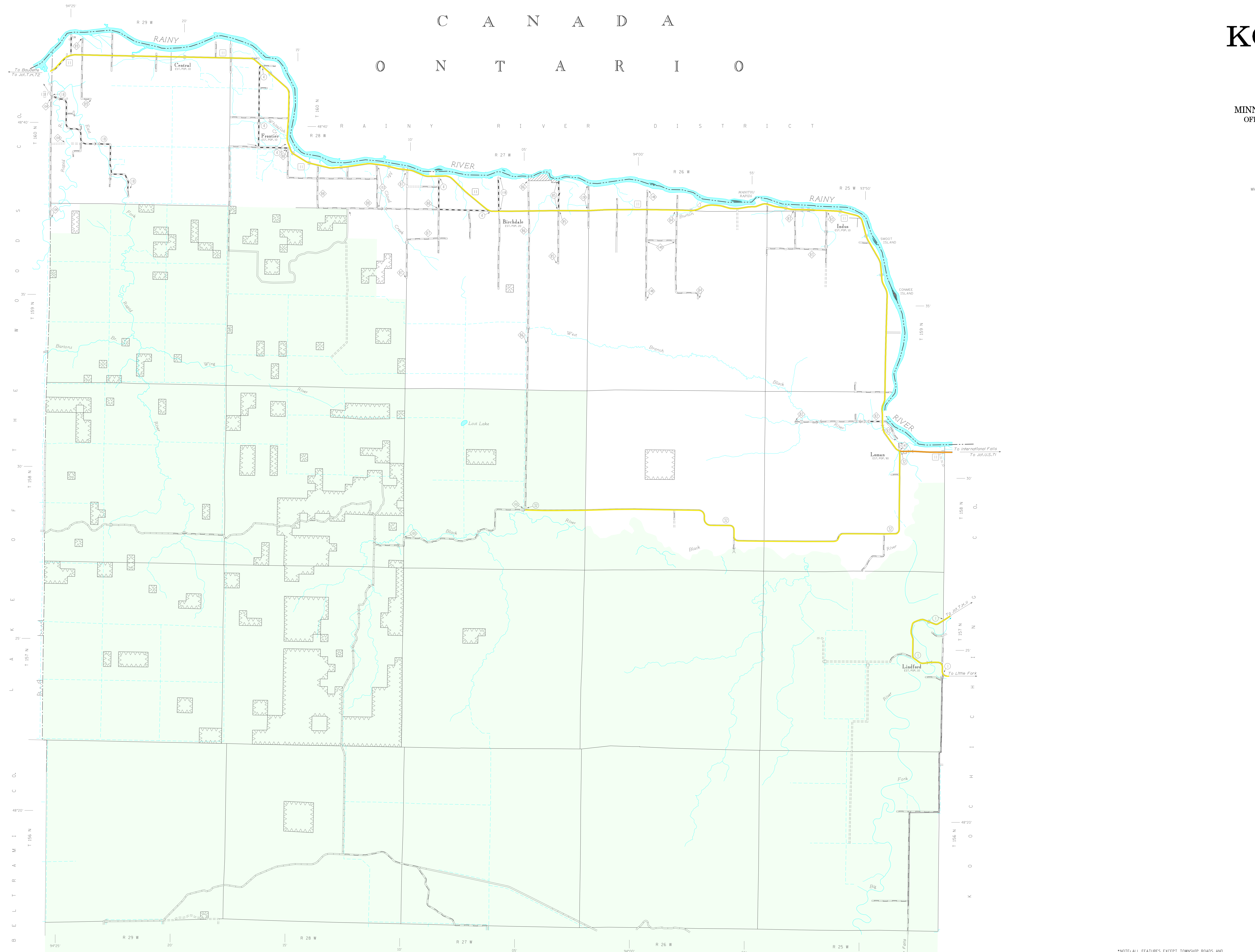
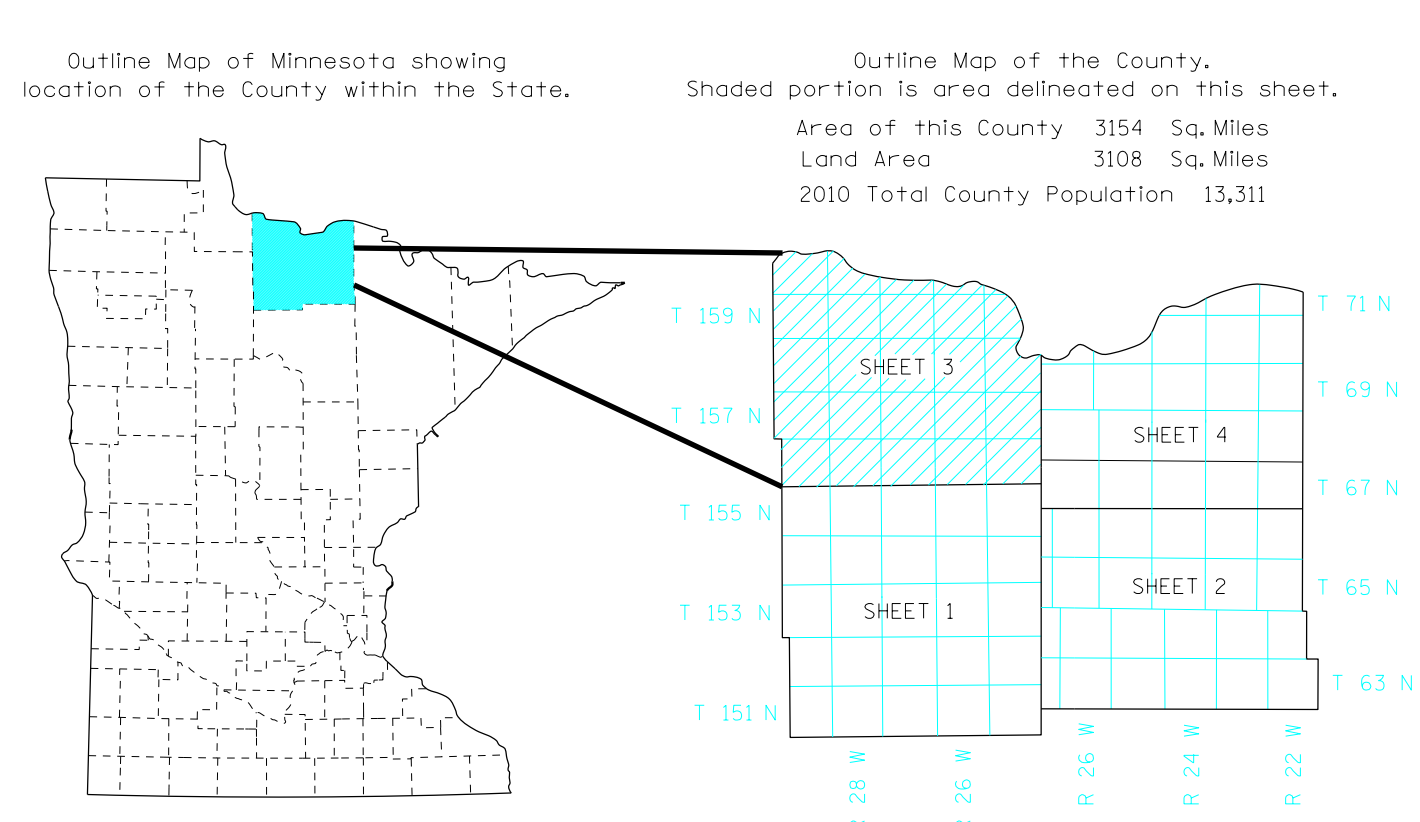

NOTE: ALL FEATURES EXCEPT TOWNSHIP ROADS AND CULTURE ARE CURRENT AS OF JANUARY 1, 2014.
NOTE: FOR DETAIL OF COUNTY STATE AID HIGHWAYS AND COUNTY ROADS IN INCORPORATED PLACES, SEE MAPS OF MUNICIPALITIES.